

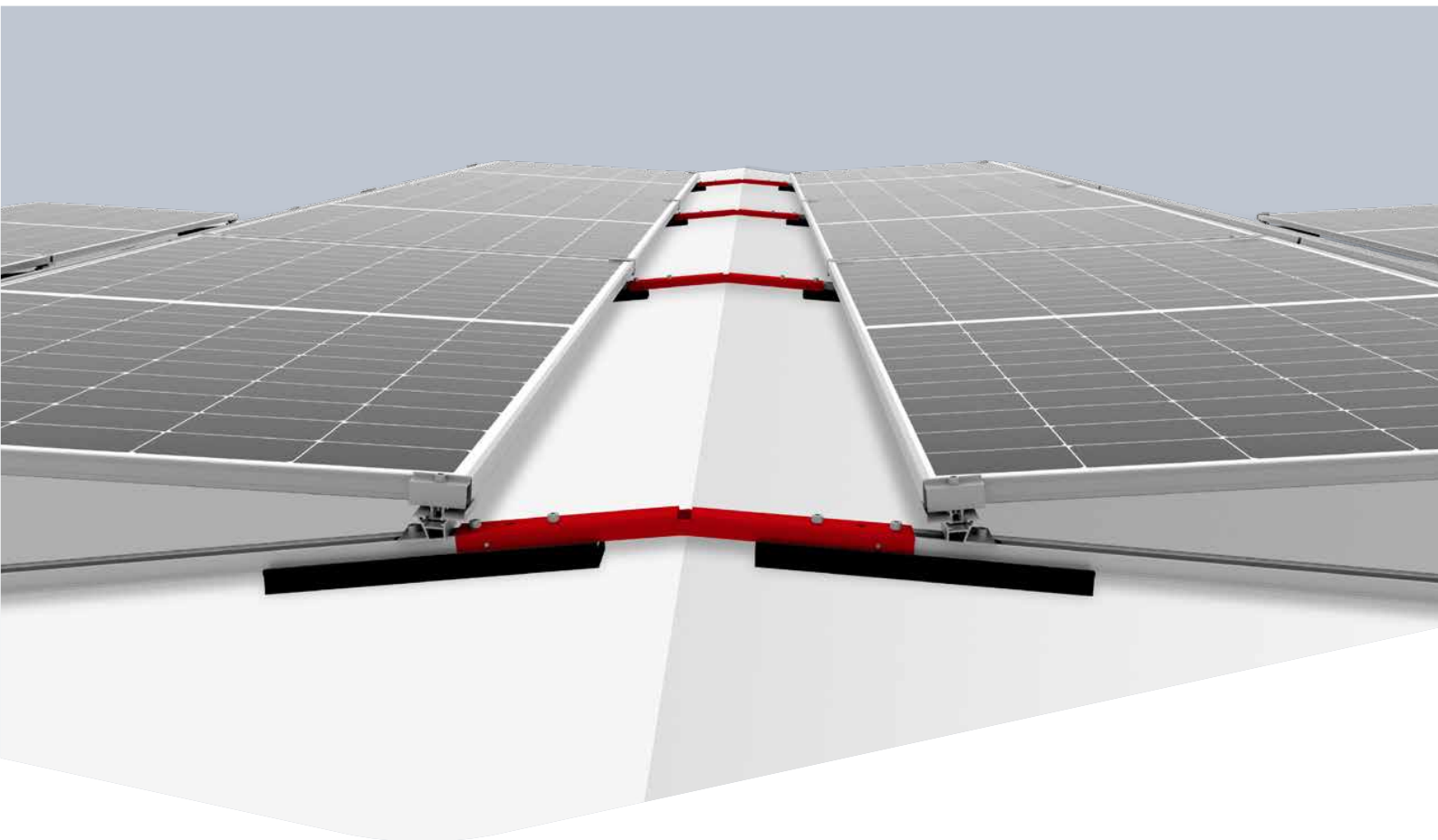

**Connecting Strength**



Assembly manual

# **RidgeConnector**

## **For Dome 6 Systems**

# Content

• Tools overview	3
• Components	4
· Easy connection via BasicRail	4
· BasicRail parallel to the ridge SingleRail	5
• Assembly	6
· BasicRail	6
· SingleRail	8
• Notes	10

## Quality tested - several certifications

K2 Systems stands for secure connections, highest quality and precision. Our customers and business partners have known that for a long time. Independent institutes have tested, confirmed and certified our capabilities and components.

Please find our quality and product certificates under:

[k2-systems.com](https://k2-systems.com)

# Tools overview



6 mm



13 mm

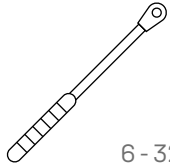

6 - 32 Nm  
(4.5 - 22.2 lb-ft)



6 mm



13 mm

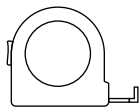

≥ 3.0 m

## Digital Toolbox

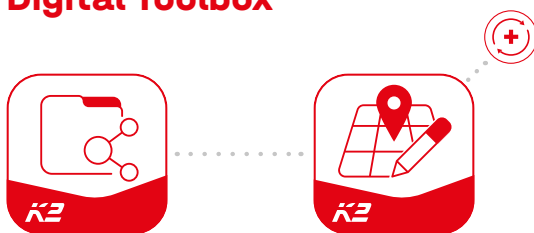

**Do you already know our digital services?** Use our K2 DocuApp now and record the first important data directly at the customer or project site.

Simply transfer the data to our online planning software K2 Base. Here you can plan your project easily, safely and quickly. You receive a detailed project report with assembly plan and static report. The K2+ interface enables seamless project data transfer to the planning tools of well-known inverter manufacturers or yield planning tools.

With the K2 DocuApp, project documentation is done quickly and easily - without any annoying paperwork.

**Get started and register now:**

[docuapp.k2-systems.com](https://docuapp.k2-systems.com) →

[base.k2-systems.com](https://base.k2-systems.com) →

# Components

## Easy connection via BasicRail

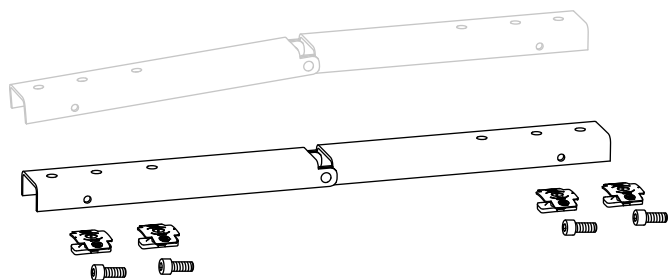
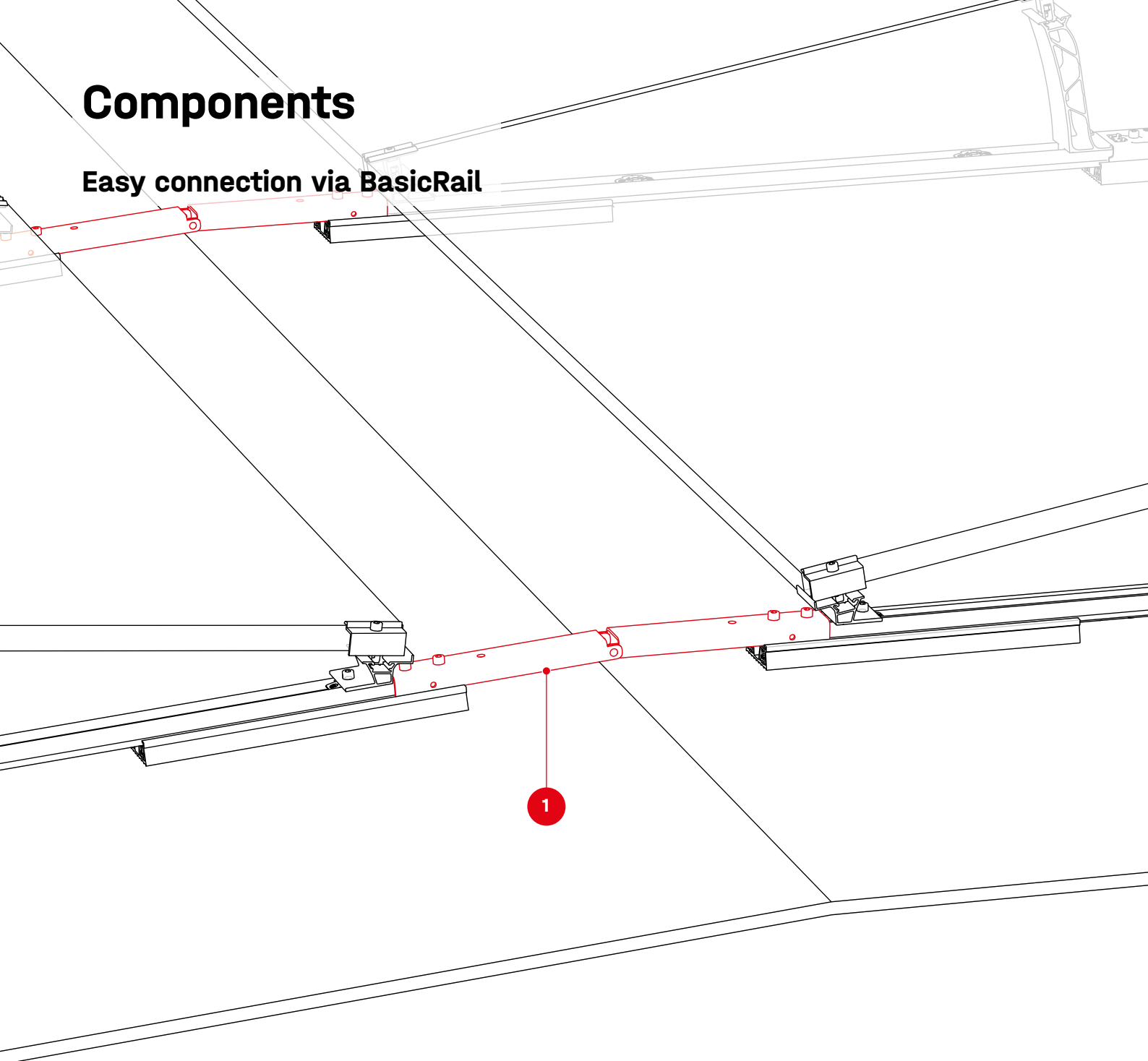

1

2004844

### RidgeConnector Set

- 1× RidgeConnector, pre-assembled (2004843)
- 4× MK2 (1001643)
- 4× hexagonal socket head cap screw (2001729)

## BasicRail parallel to the ridge SingleRail

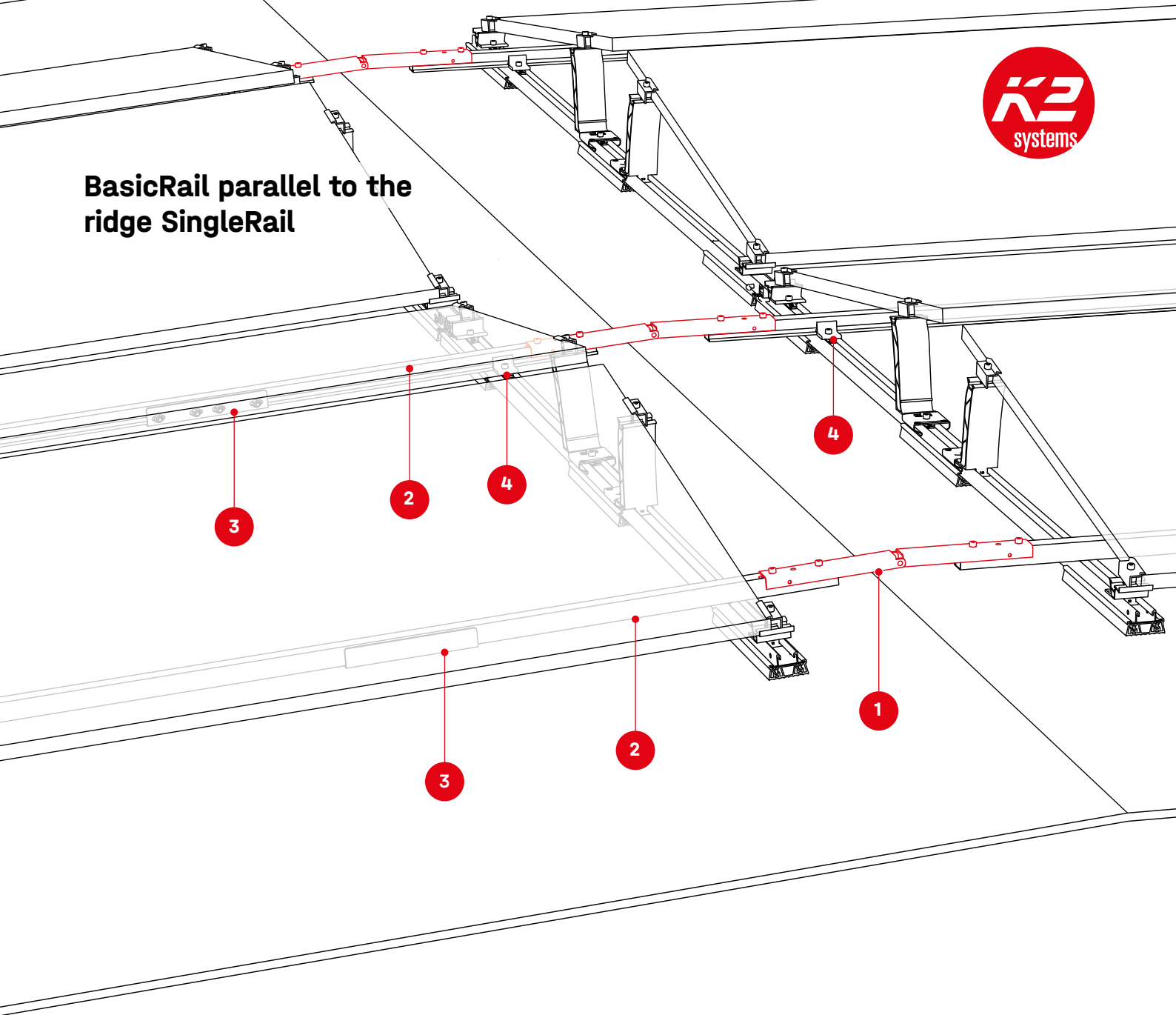

**2** 2004413  
SingleRail 36 Light

**3** 2001976  
Rail connector set  
SingleRail 36

**4** 2003145  
Climber 36/50 Set

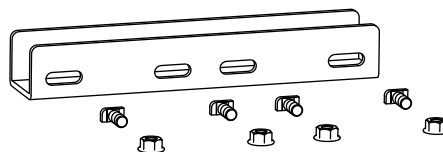
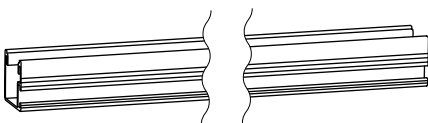

# Assembly

## BasicRail

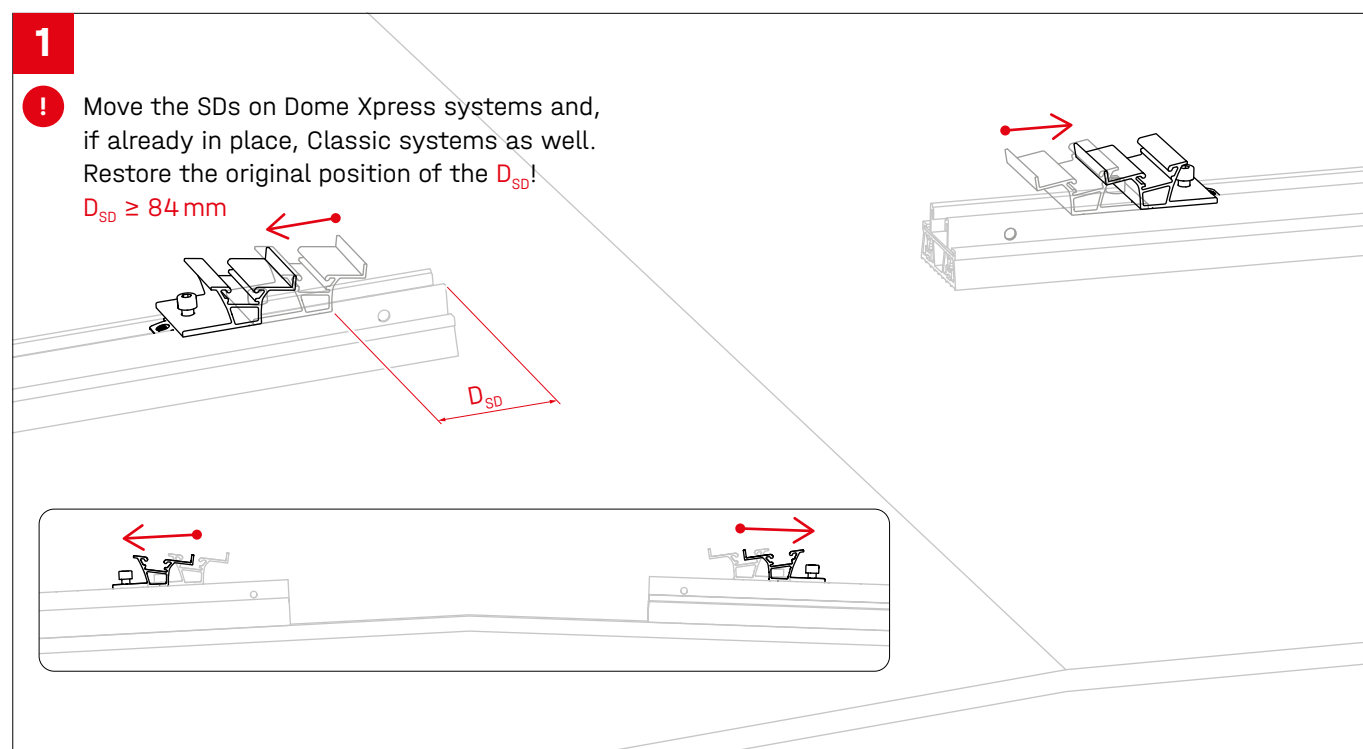
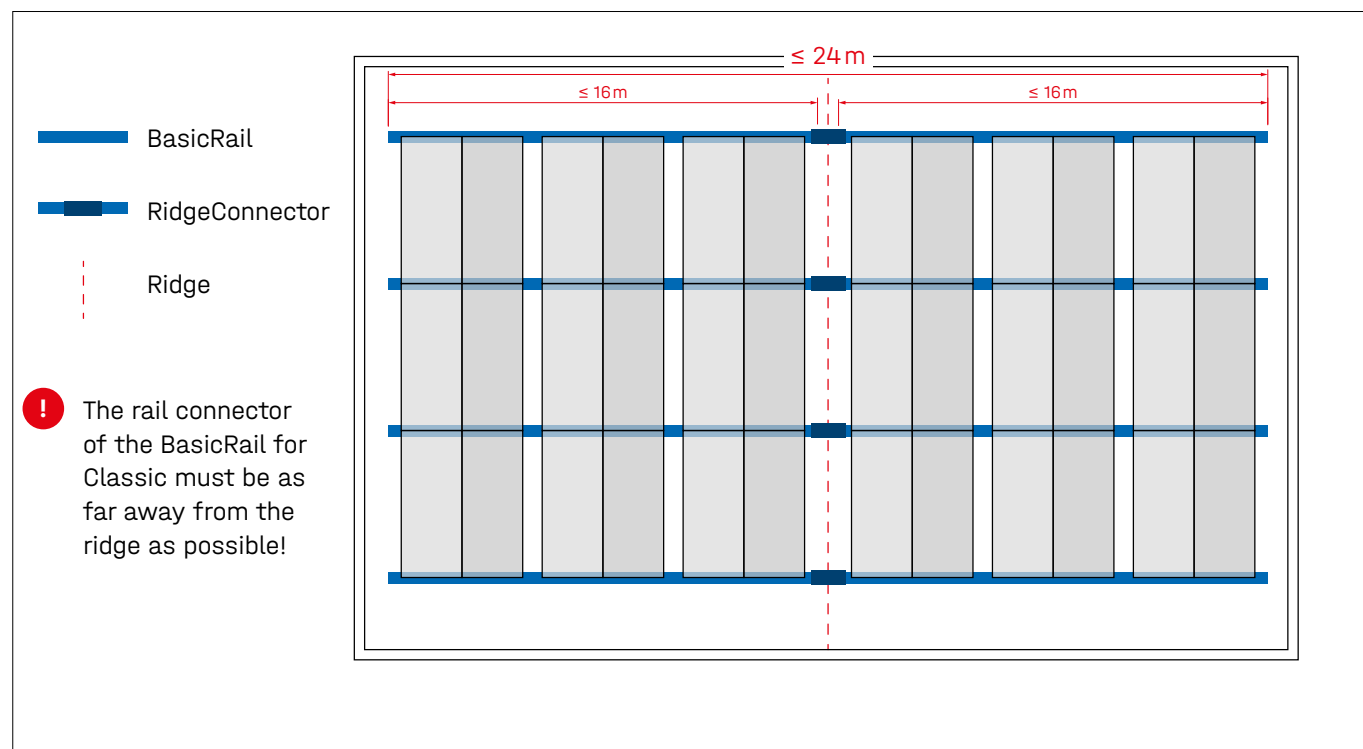

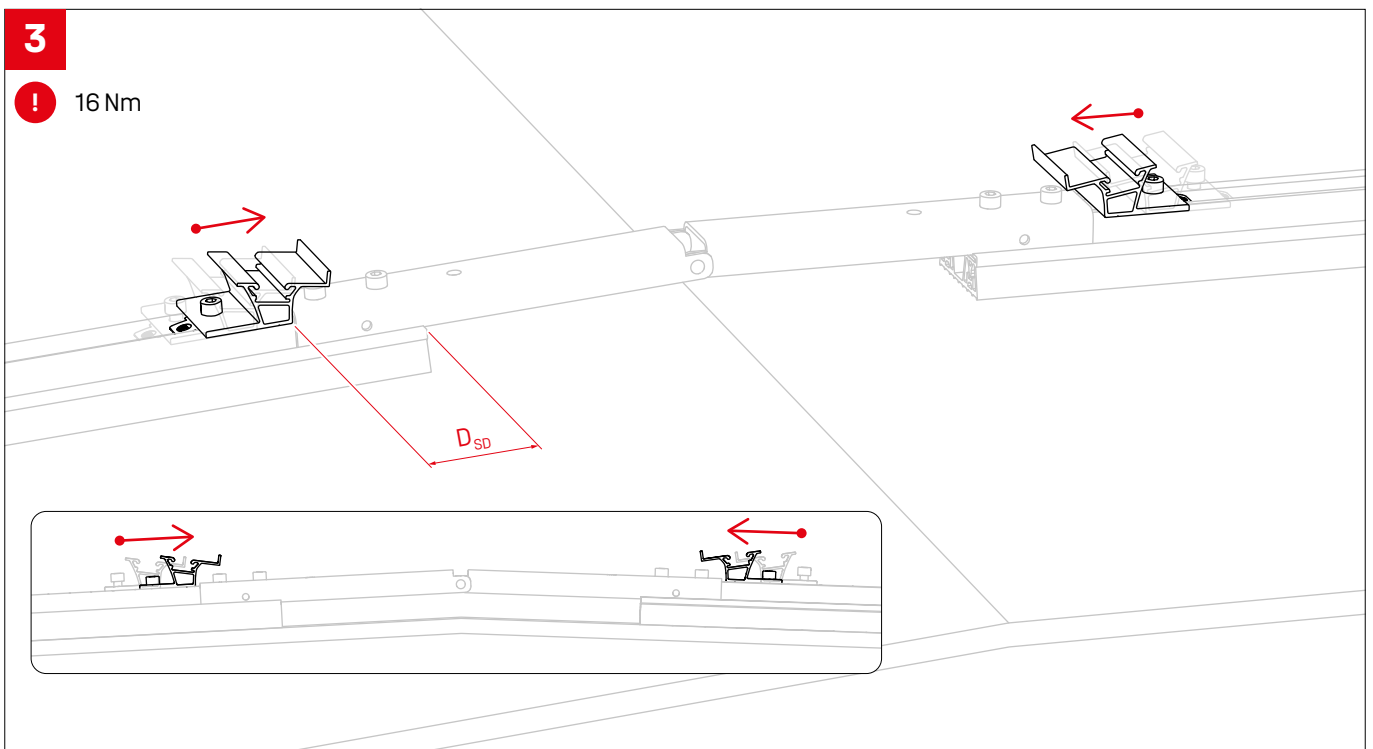
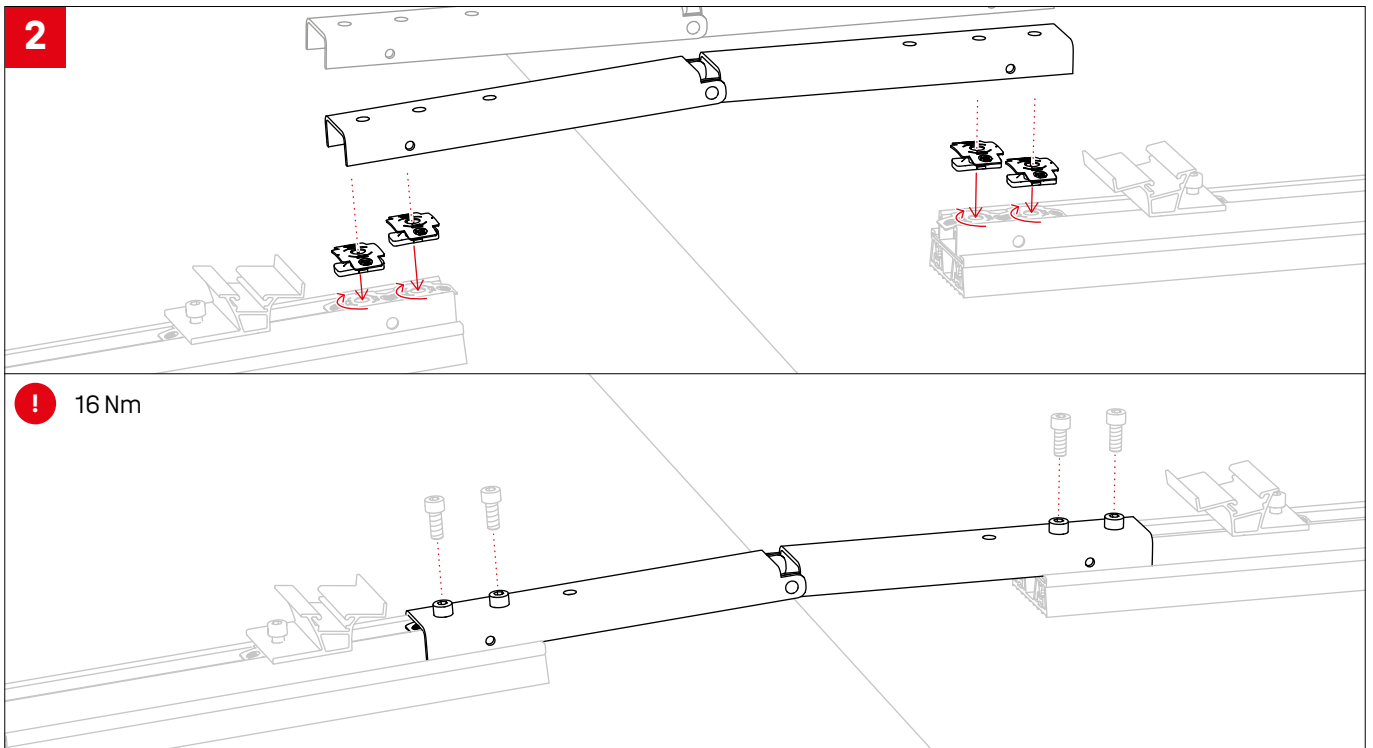

# SingleRail

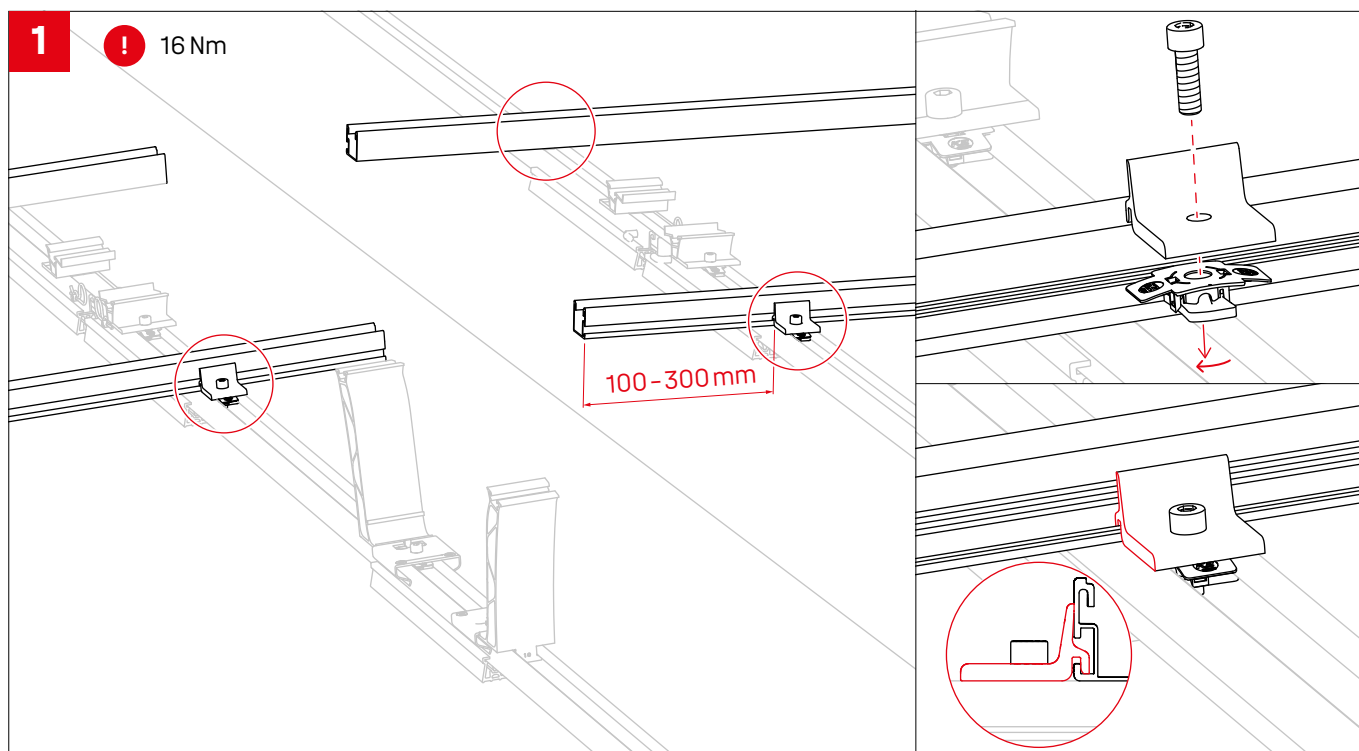
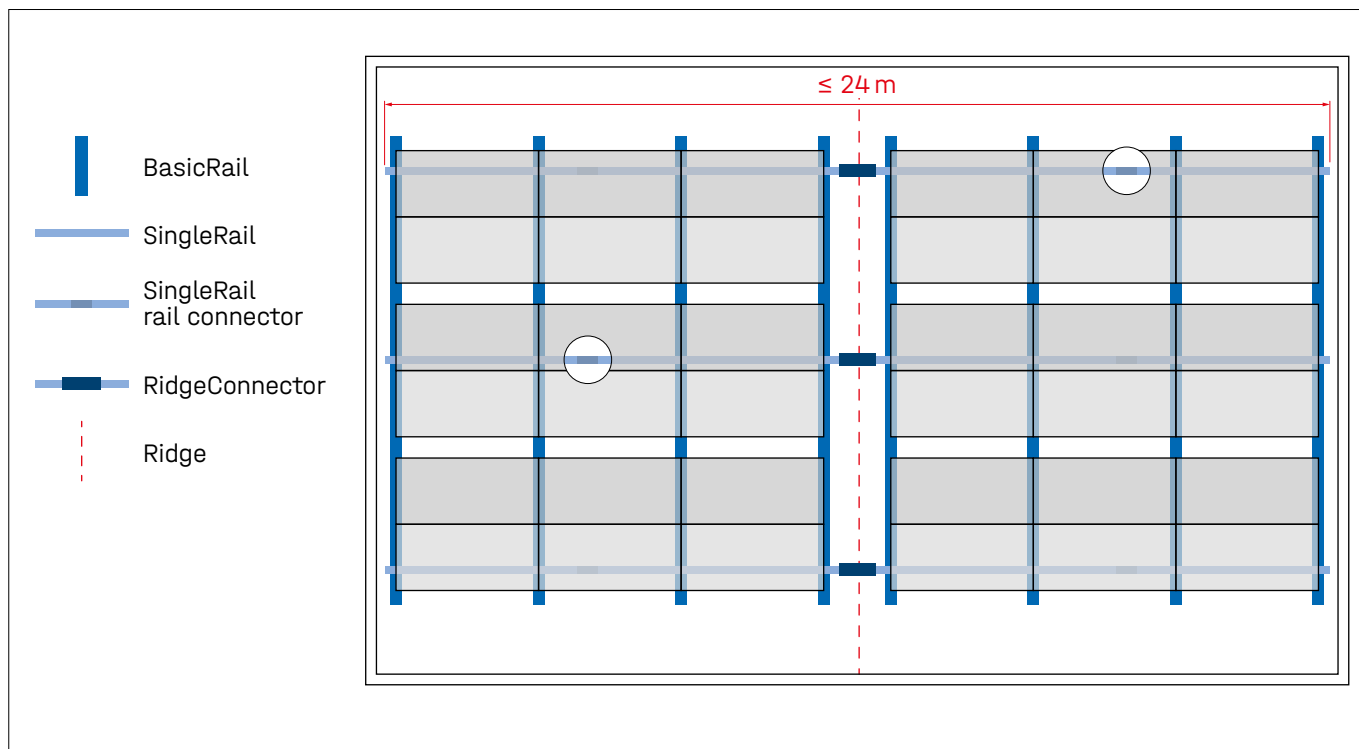



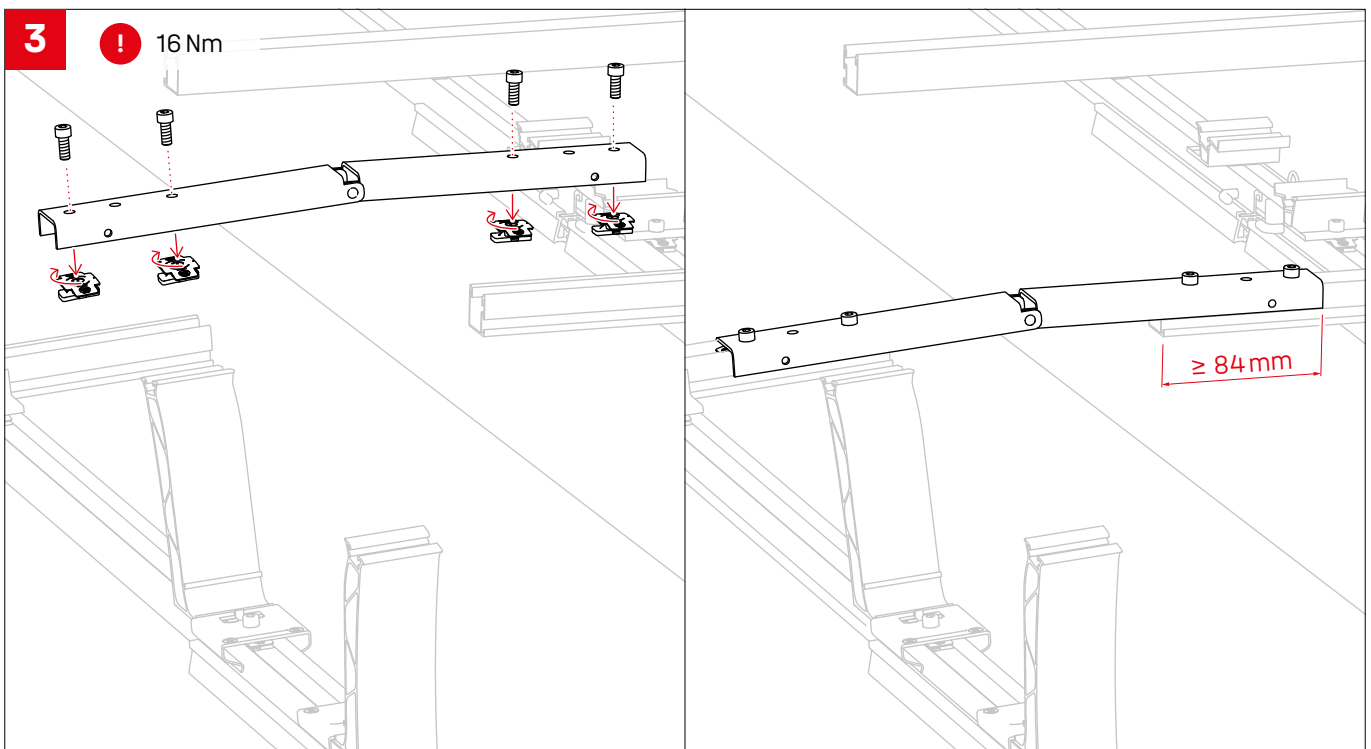
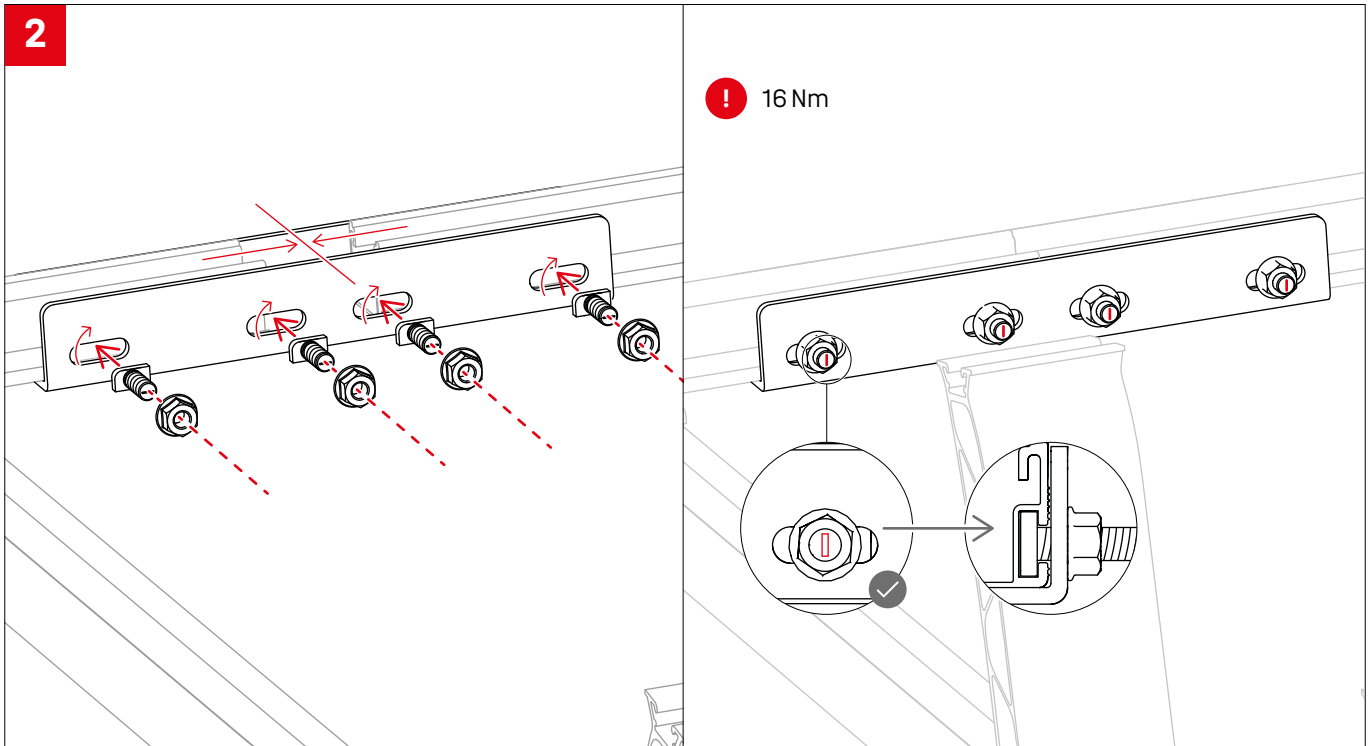

## Notes

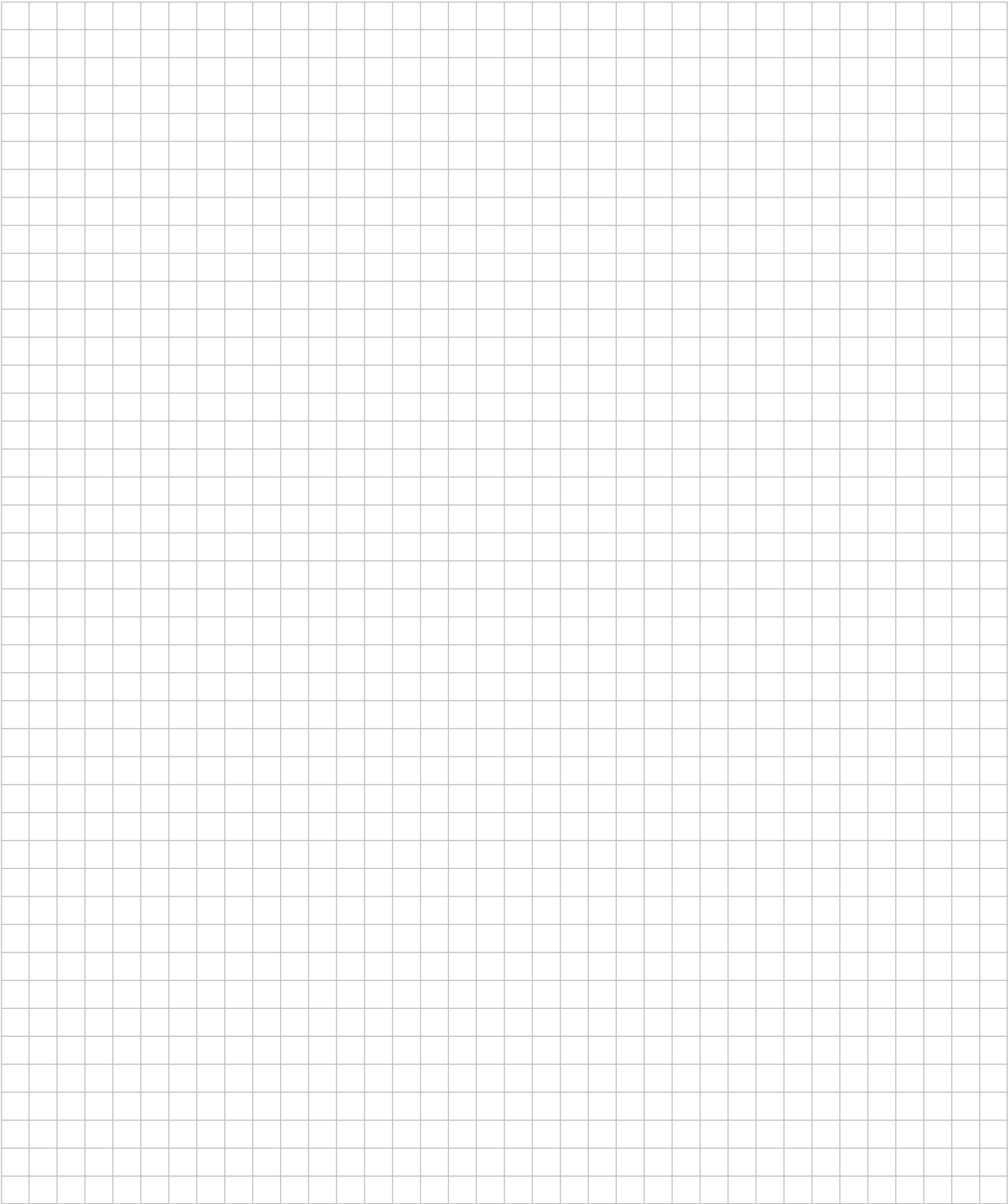



# Connecting Strength

## Thank you for choosing a K2 mounting system.

Mounting systems from K2 Systems are quick and easy to install. We hope these instructions have helped. Please contact us with any questions or suggestions for improvement. Our contact data:

- [k2-systems.com/en/contact](https://k2-systems.com/en/contact)
- **Service Hotline: +49 7159 42059-0**

Our General Terms of Business apply. Please refer: [k2-systems.com](https://k2-systems.com)

### K2 Systems GmbH

Haldenstraße 1 · 71272 Renningen · Germany  
+49 (0) 7159 - 42059 - 0 · [info@k2-systems.com](mailto:info@k2-systems.com) · [k2-systems.com](https://k2-systems.com)

RidgeConnector Assembly EN V1 | 1025 · Subject to change  
Product illustrations are exemplary and may differ from the original.