

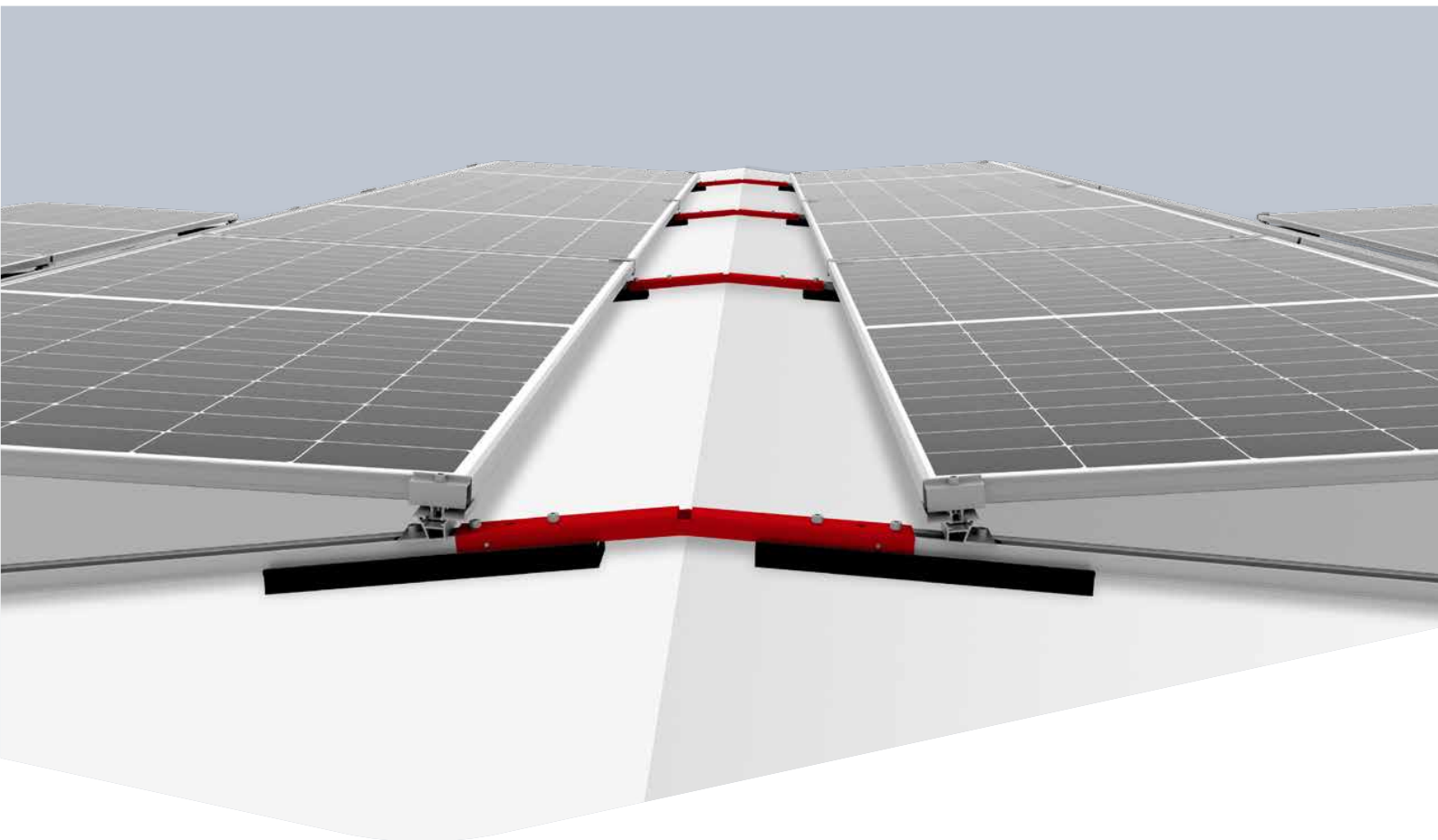

Connecting Strength



Assembly instructions

RidgeConnector

For Dome 6 Systems

Content

• Tools overview	3
• Components	4
· Easy connection via BasicRail	4
· BasicRail parallel to the ridge SingleRail	5
• Possible applications	6
· Criteria: Ridge connection and enquiry	6
· Ridge area	6
· Ratio of module blocks	7
· Gaps and thermal breaks	7
• Assembly	8
· BasicRail	8
· SingleRail	10

Quality tested - several certifications

K2 Systems stands for secure connections, highest quality and precision. Our customers and business partners have known that for a long time. Independent institutes have tested, confirmed and certified our capabilities and components.

Please find our quality and product certificates under:

k2-systems.com

Tools overview

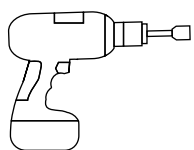

6 mm



13 mm

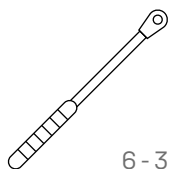

6 - 32 Nm
(4.5 - 22.2 lb-ft)



6 mm



13 mm

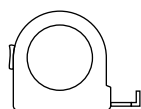

≥ 3.0 m

Digital Toolbox

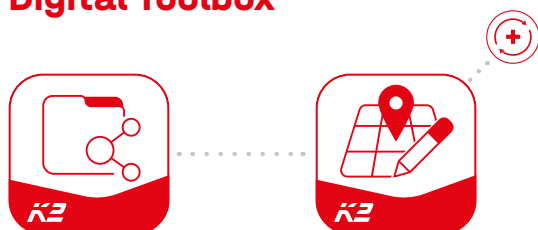

Do you already know our digital services? Use our K2 DocuApp now and record the first important data directly at the customer or project site.

Simply transfer the data to our online planning software K2 Base. Here you can plan your project easily, safely and quickly. You receive a detailed project report with assembly plan and static report. The K2+ interface enables seamless project data transfer to the planning tools of well-known inverter manufacturers or yield planning tools.

With the K2 DocuApp, project documentation is done quickly and easily - without any annoying paperwork.

Get started and register now:

docuapp.k2-systems.com →

base.k2-systems.com →

Components

Easy connection via BasicRail

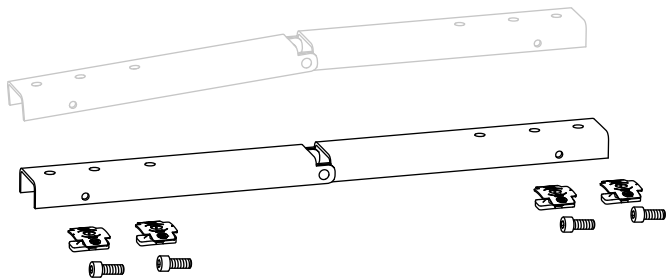
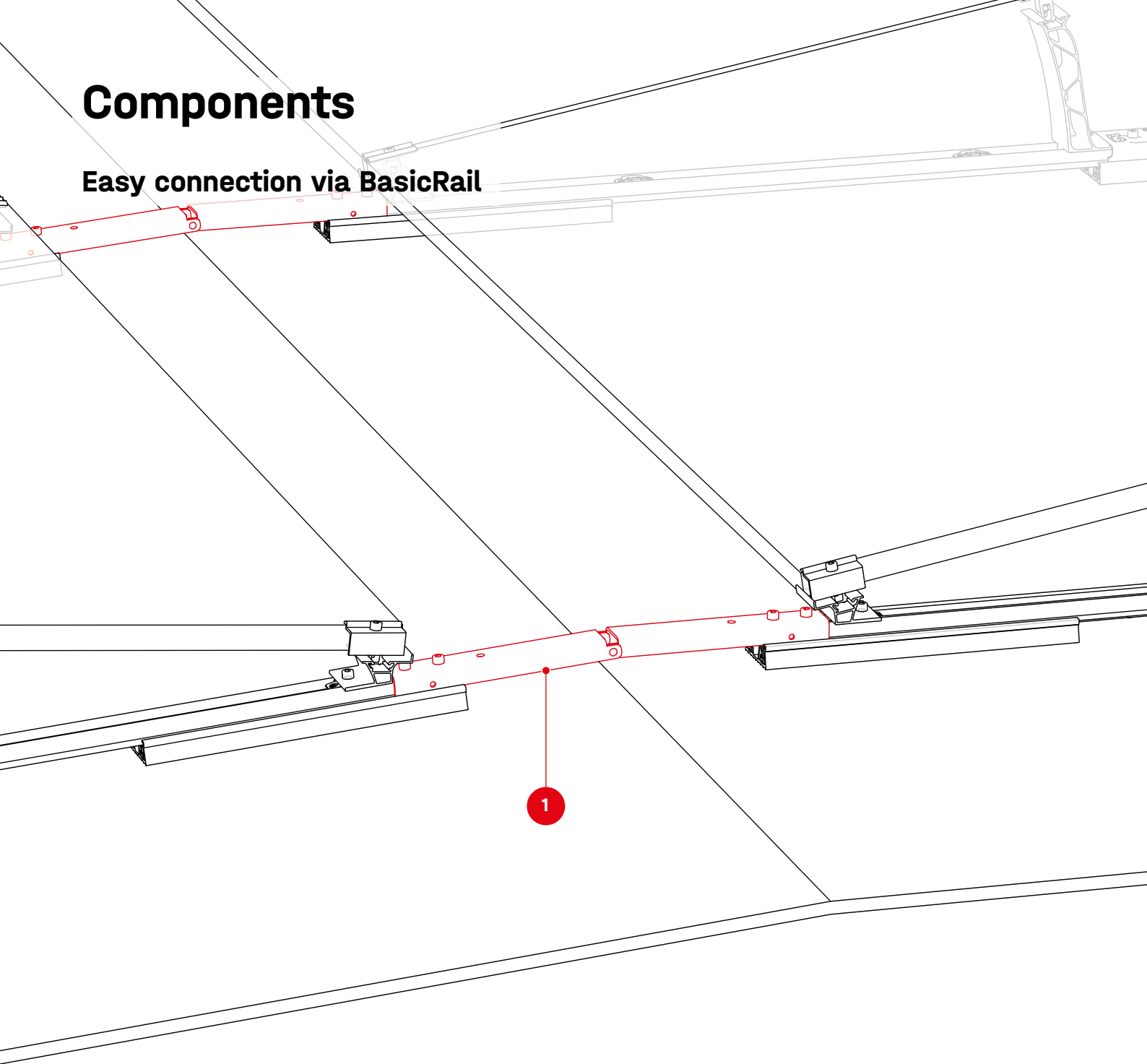

1

2004844

RidgeConnector Set

- 1× RidgeConnector, pre-assembled (2004843)
- 4× MK2 (1001643)
- 4× hexagonal socket head cap screw (2001729)

BasicRail parallel to the ridge SingleRail

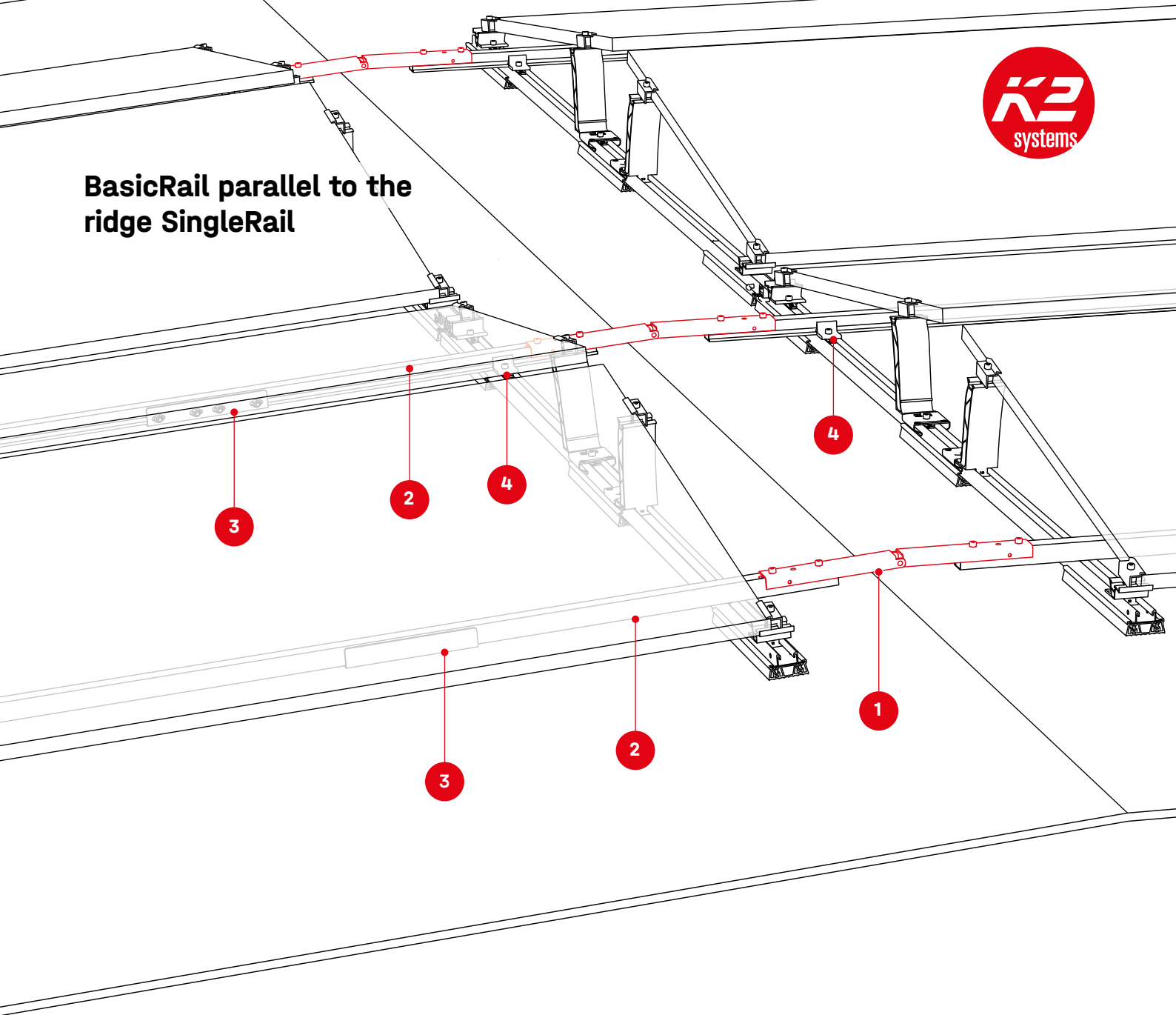

2 2004413
SingleRail 36 Light

3 2001976
Rail connector set
SingleRail 36

4 2003145
Climber 36/50 Set

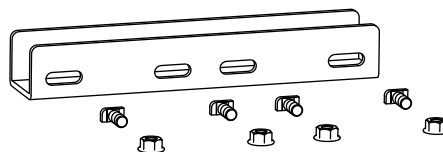
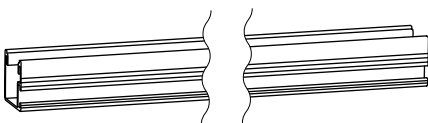

Possible applications

Criteria: Ridge connection and enquiry

- **Compatible mounting systems:**
 - Dome 6 Xpress and Classic
 - S-Dome 6 and D-Dome 6
- **Module clamping:** Corner and longitudinal clamping
- **Alignment:** Connection via BasicRail or SingleRail
- **Roof pitch:** $\geq 4^\circ$ to $\leq 10^\circ$
- **Building height:** ≤ 25 m
- **Ridge must be marked:** Create line obstacle in K2 Base and name it clearly



Ridge area

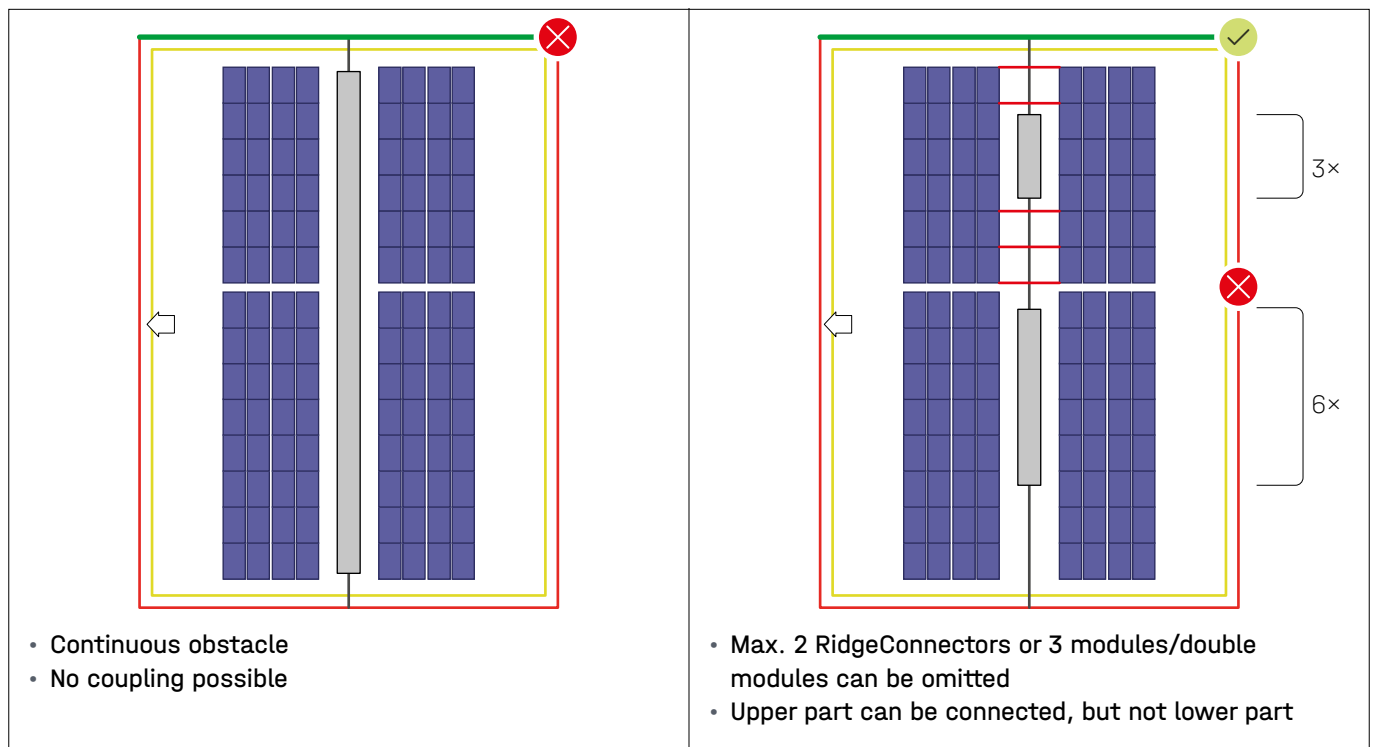

Ratio of module blocks

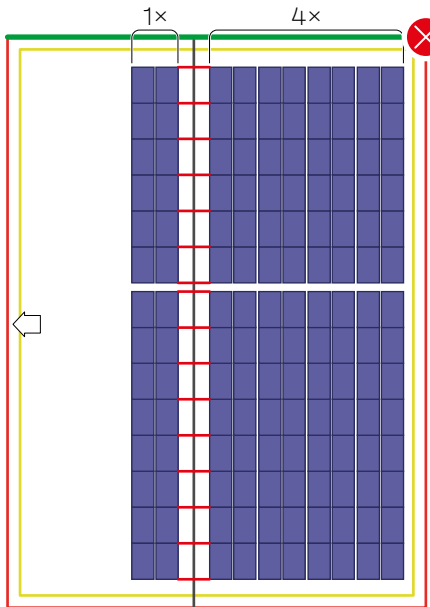
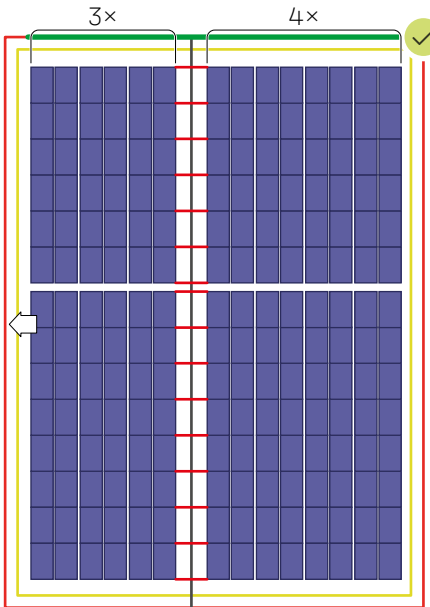
 <ul style="list-style-type: none"> • Number of modules per row $\geq 1:2$; here 1:4 • Direction of BasicRail not relevant 	 <ul style="list-style-type: none"> • Number of modules per row $\geq 1:2$; here 3:4 • Direction of BasicRail not relevant
--	---

Gaps and thermal breaks

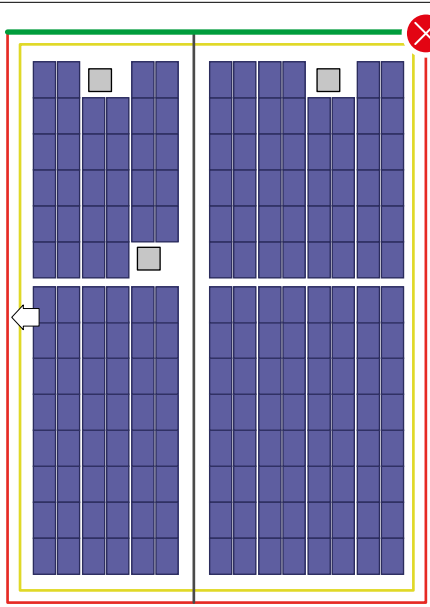
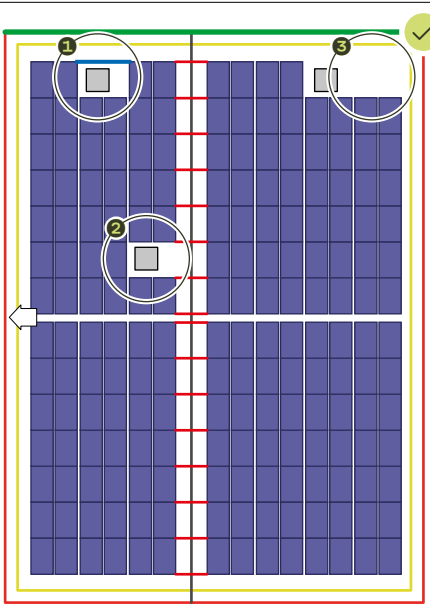
 <ul style="list-style-type: none"> • Loose double modules • No connection option between module arrays 	 <ul style="list-style-type: none"> ❶ Empty connecting rails between modules ❷ Thermal separation shifted ❸ Delete module
--	--

Assembly

BasicRail

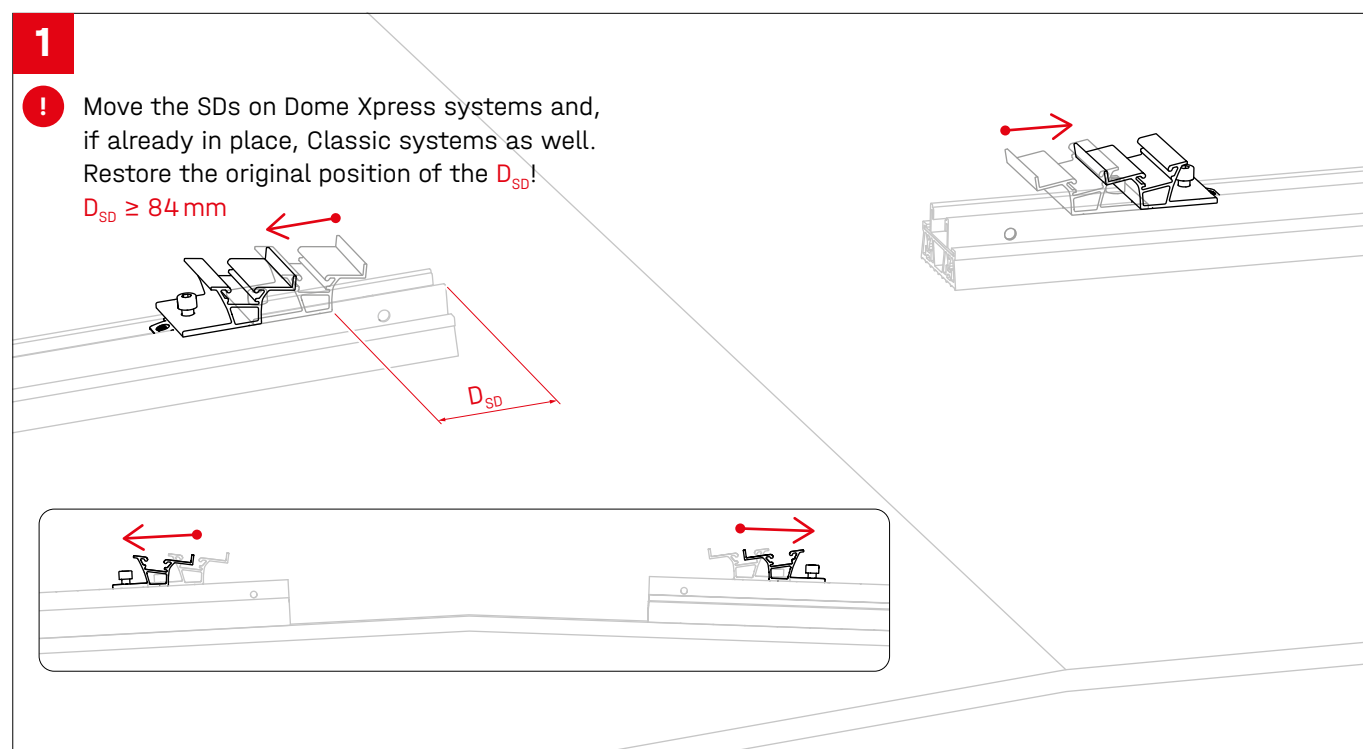
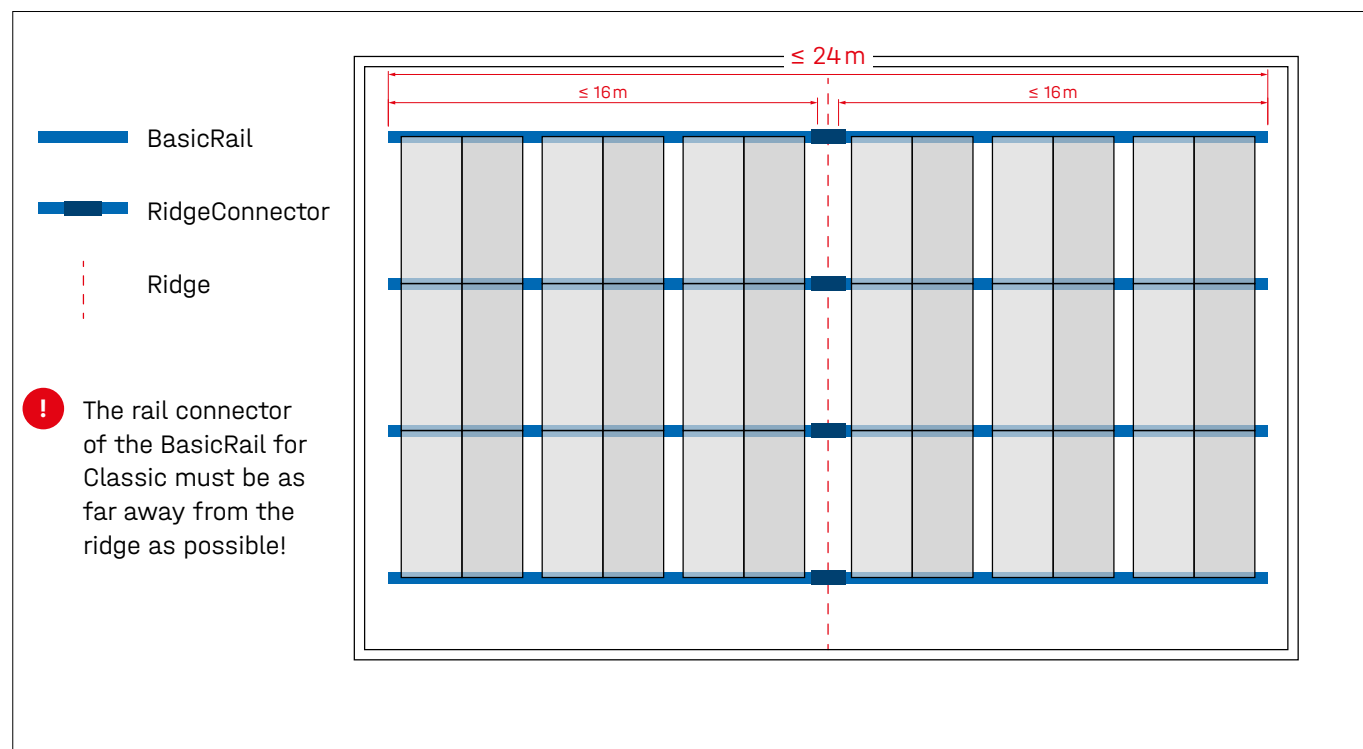

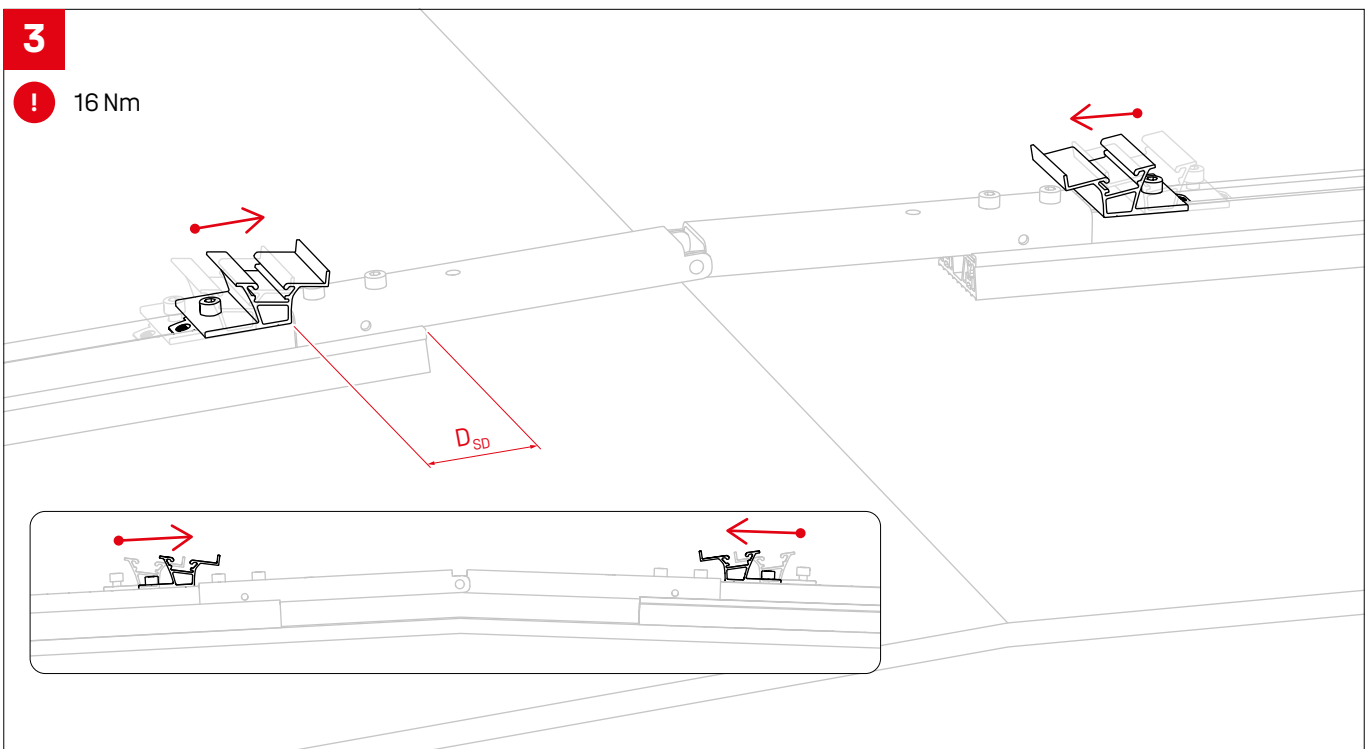
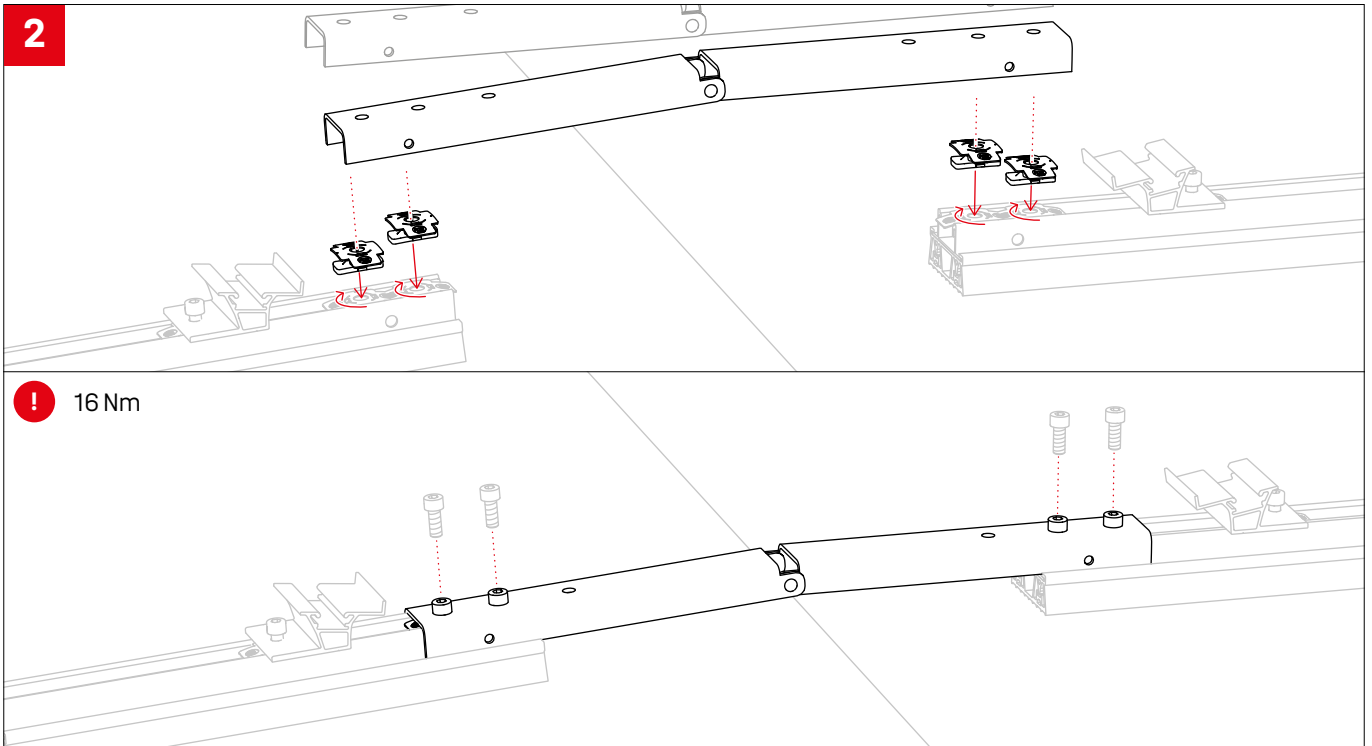

SingleRail

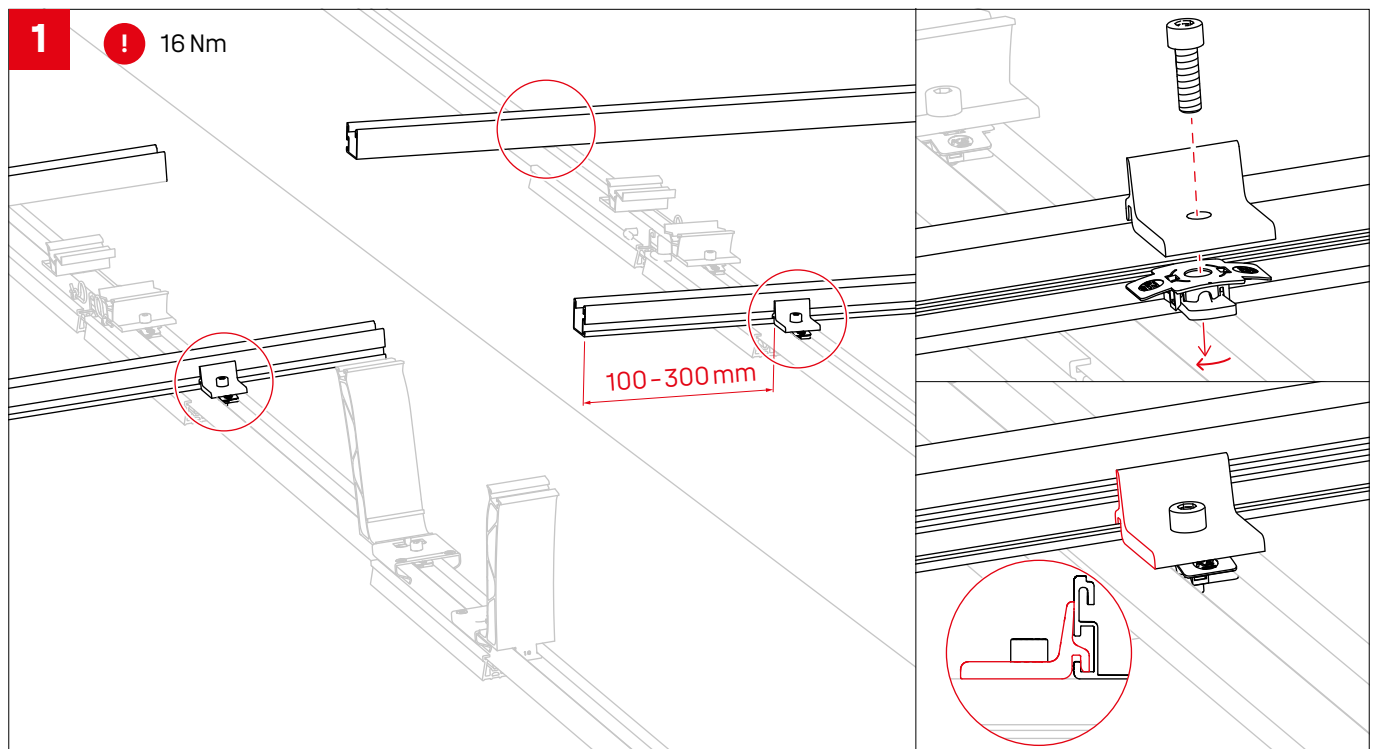
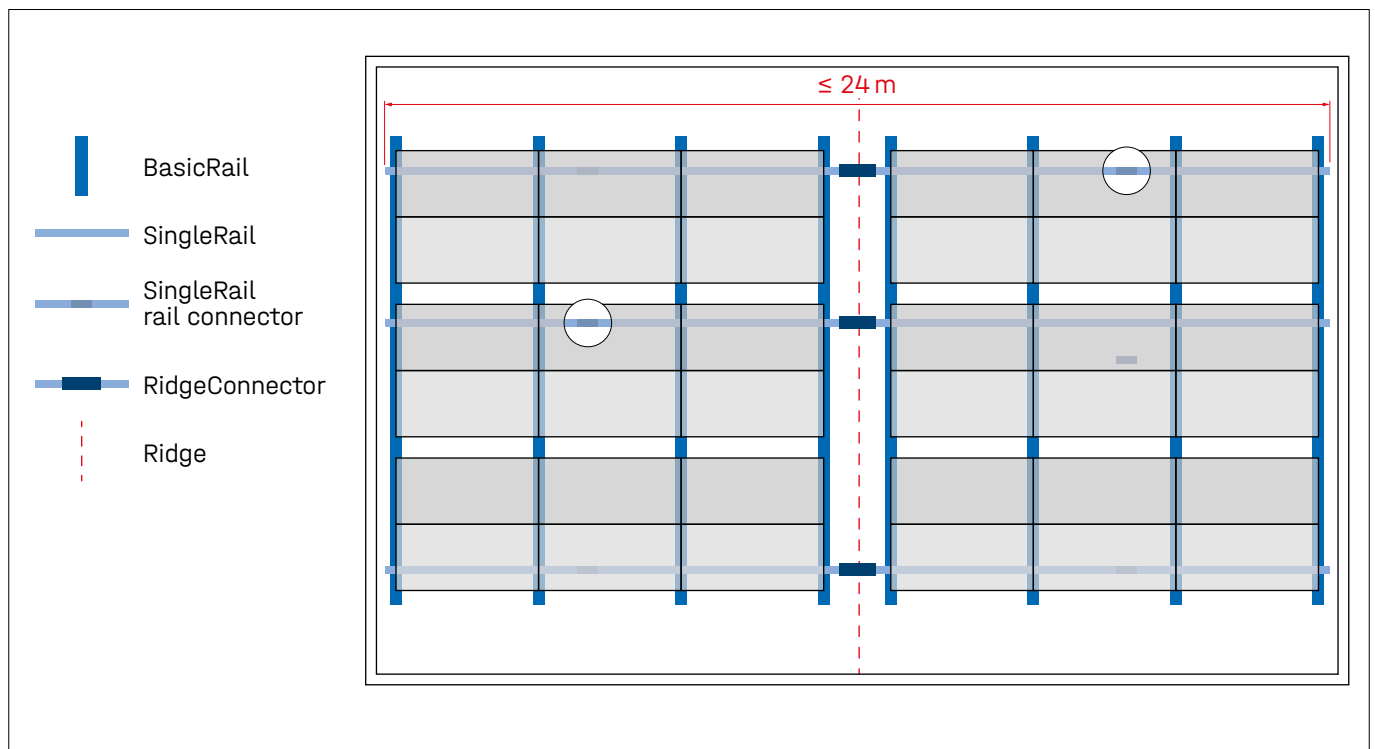

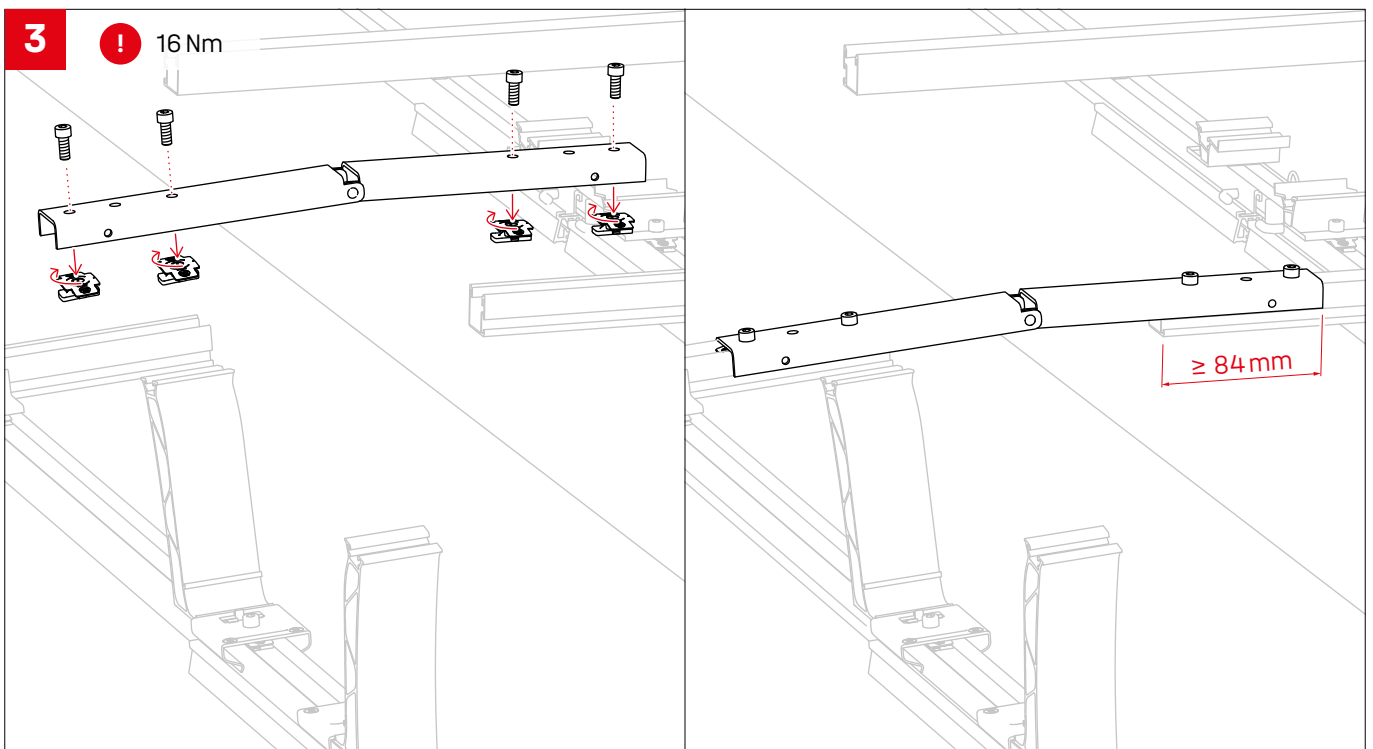
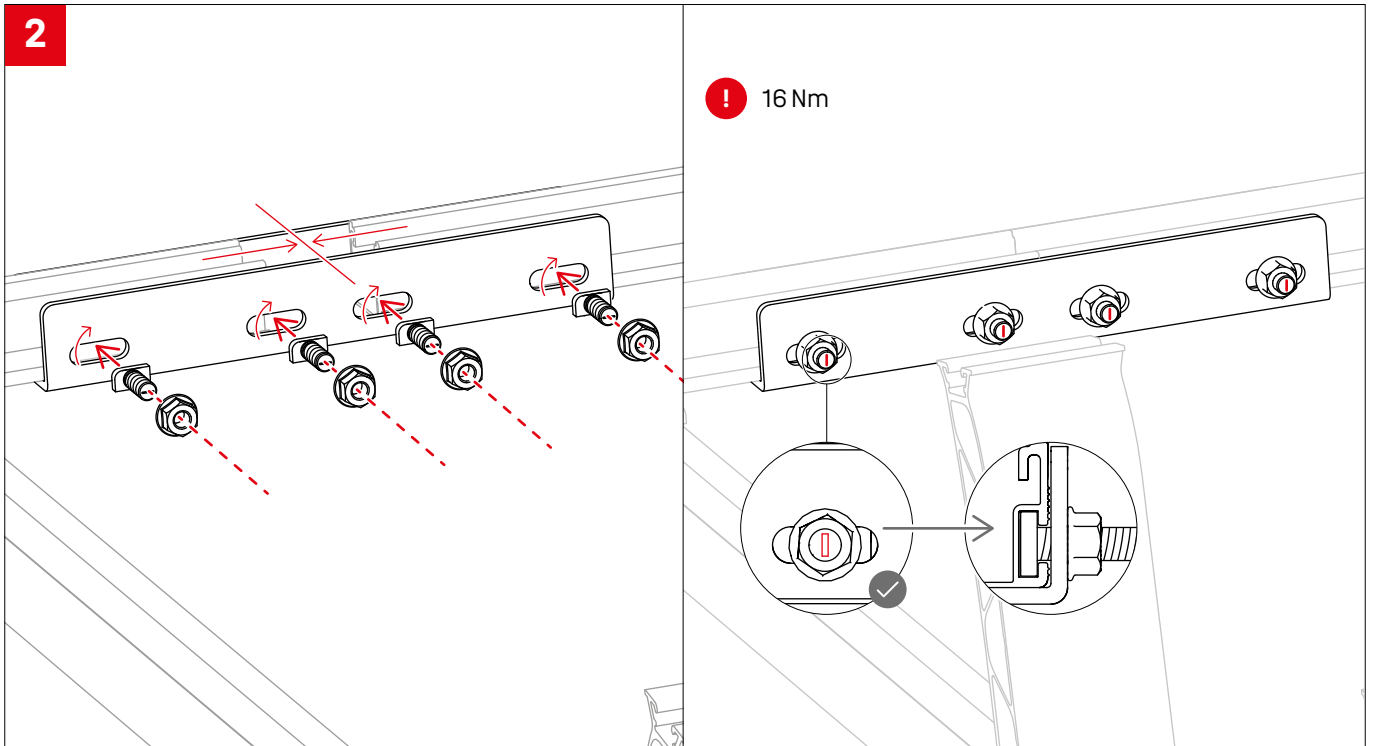



Connecting Strength

Thank you for choosing a K2 mounting system.

Mounting systems from K2 Systems are quick and easy to install. We hope these instructions have helped. Please contact us with any questions or suggestions for improvement. Our contact data:

- k2-systems.com/en/contact
- **Service Hotline: +49 7159 42059-0**

Our General Terms of Business apply. Please refer: k2-systems.com

K2 Systems GmbH

Haldenstraße 1 · 71272 Renningen · Germany
+49 (0) 7159 - 42059 - 0 · info@k2-systems.com · k2-systems.com

RidgeConnector Assembly EN V2 | 0226 · Subject to change
Product illustrations are exemplary and may differ from the original.