



Assembly Manual

SingleRail IFP

Membrane and bitumen roofing



Connecting Strength

k2-systems.com

Content

• Tools overview	3
• General safety information	4
• The following guidelines apply	5
· Planning with K2 Base	5
· Roof requirements	5
· Important mounting instructions	5
• Components	6
• Assembly	8
· Thermal separations – landscape	8
· Set anchors – landscape	8
· Thermal separations – portrait	9
· Set anchors – portrait	9
· Rail attachment	10
· Connecting rails	10
· Module assembly – End clamp	11
· Module assembly – Middle clamp	11
• Module spacing in rail direction	12
· Landscape	12
· Portrait	12
• Equipotential bonding/Module frame earthing	13
· TerraGrif K2SZ	13
· TerraGrif QL	13
• Optional	14
· Cable management with Cable Manager	14
• Notes	15

Quality tested – several certifications

K2 Systems stands for secure connections, highest quality and precision. Our customers and business partners have known that for a long time. Independent institutes have tested, confirmed and certified our capabilities and components.

Please find our quality and product certificates under:

k2-systems.com

Tools overview



6 mm

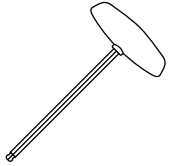

6 mm

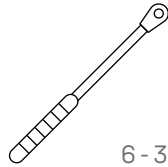

6 - 30 Nm
(4.5 - 22.2 lb-ft)



6 mm

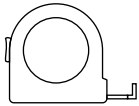
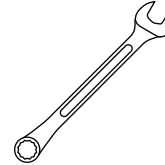

≥ 3.0 m



≥ 6.0 m

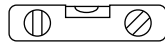

Digital Toolbox



Do you already know our digital services? Use our K2 DocuApp now and record the first important data directly at the customer or project site.

Simply transfer the data to our online planning software K2 Base. Here you can plan your project easily, safely and quickly. You receive a detailed project report with assembly plan and static report.

The K2+ interface enables seamless project data transfer to the planning tools of well-known inverter manufacturers or yield planning tools.

Get started and register now:

docuapp.k2-systems.com →

base.k2-systems.com →

General safety information

Please note that our general mounting instructions must be followed at all times and can be viewed online at [k2-systems.com](https://www.k2-systems.com)

- The equipment may only be installed and operated by qualified and adequately trained installers.
- Prior to installation, ensure that the product complies with on-site static loading requirements. For roof-mounted systems, the roof load-bearing capacity must always be checked.
- National and local building regulations and environmental requirements must be adhered to.
- Compliance with health and safety regulations, accident prevention guidelines and applicable standards is required.
 - Protective equipment such as safety helmet, boots and gloves must be worn.
 - Roofing works must be in accordance with roofing regulations utilising fall protection safeguards when eaves height exceeds 3 m.
 - At least two people must be present for the duration of the installation work in order to provide rapid assistance in the event of an emergency.
- K2 mounting systems are continuously developed and improved and the installation process may thereby change at any time. Prior to installation consult our website at www.k2-systems.com/en/technical-information for up-to-date instructions. We can send you the latest version on request.
- The assembly instructions of the module manufacturer must be adhered to.
- Equipotential bonding/grounding/earthing between individual parts is to be performed according to country specific standards, as well as national laws and regulations.
- At least one copy of the assembly instructions should be available on site throughout the duration of the installation.
- Failure to adhere to our general safety and assembly instructions and not using all system components, K2 is not liable for any resulting defects or damages. We do not accept liability for any damage resulting in the use of competitor's parts. Warranty is excluded in such cases.
- K2 Systems GmbH reserves the right to exclude liability in case of disregard of our General Safety Instructions as well as in case of installation or mounting of components of a competitor.
- If all safety instructions are adhered to and the system is correctly installed, there is a product warranty entitlement of 12 years! We strongly recommend reviewing our terms of guarantee, which can be viewed at [k2-systems.com/en/warranty-terms-and-conditions](https://www.k2-systems.com/en/warranty-terms-and-conditions) We will also send this information on request.
- Dismantling of the system is performed in reverse order to the assembly.
- K2 stainless steel components are available in different corrosion resistance classes. Each structure or component must be carefully checked for possible corrosion exposure.

The following guidelines apply



This System can be used without further testing by K2 systems in the following standard conditions. It is also suitable for higher requirements. However, if a value exceeds the standard conditions, please contact K2 Systems.



Planning with K2 Base

We recommend our free online software K2 Base for the planning. In five steps, you can plan the right assembly system and get an installation recommendation, a bill of materials and the structural analysis report. Simply register and start planning: base.k2-systems.com

- The anchors are not included in the scope of delivery of K2 and must be provided on site.
- The specifications (approvals, data sheets, installation instructions) of the respective manufacturer apply to the use of the anchors. K2 will not provide any further information on installation and manufacture.



Roof requirements

- It is essential to check that the roof structure has sufficient residual load capacity and that the pressure capacity of the roof insulation (where present) is not exceeded.
- Roof pitch of: $\geq 5^\circ - \leq 35^\circ$
- Sufficient load reserves to support the PV system.

- Sufficient impermeability must be ensured after installation of the anchors. Depending on the project, a suitable sealing measure must be properly implemented in the water-bearing layer.
- Subsequent leaks (caused by components provided by the customer, or the interaction of these with the components provided by K2, or other reasons) are not the responsibility of K2, provided they are not due to material defects in the components supplied by K2.



Important mounting instructions

- The system is suitable for roofs with the following load bearing substructure: trapezoidal sheet metal, wood and concrete.
- On-site general standards and regulations for lightning protection must be observed and consultation with a specialist to create a lightning protection concept is recommended (use lightning protection clamp if necessary).
- For information regarding the module clamping range, see the model manufacture's assembly manual.
- Do not step on anchors or rails, as these are not climbing assists.
- The selection, quantity, product properties and manufacture of the anchors must be decided and checked by those responsible for the project.

- Testing the suitability of the insulation layer is the responsibility of the building owner and is not the responsibility of K2.
- For portrait installation, ensure that the adapter plate is aligned "upwards" in the direction of the ridge so that the rail is above the threaded anchor rod (see p10, step 2).

Components

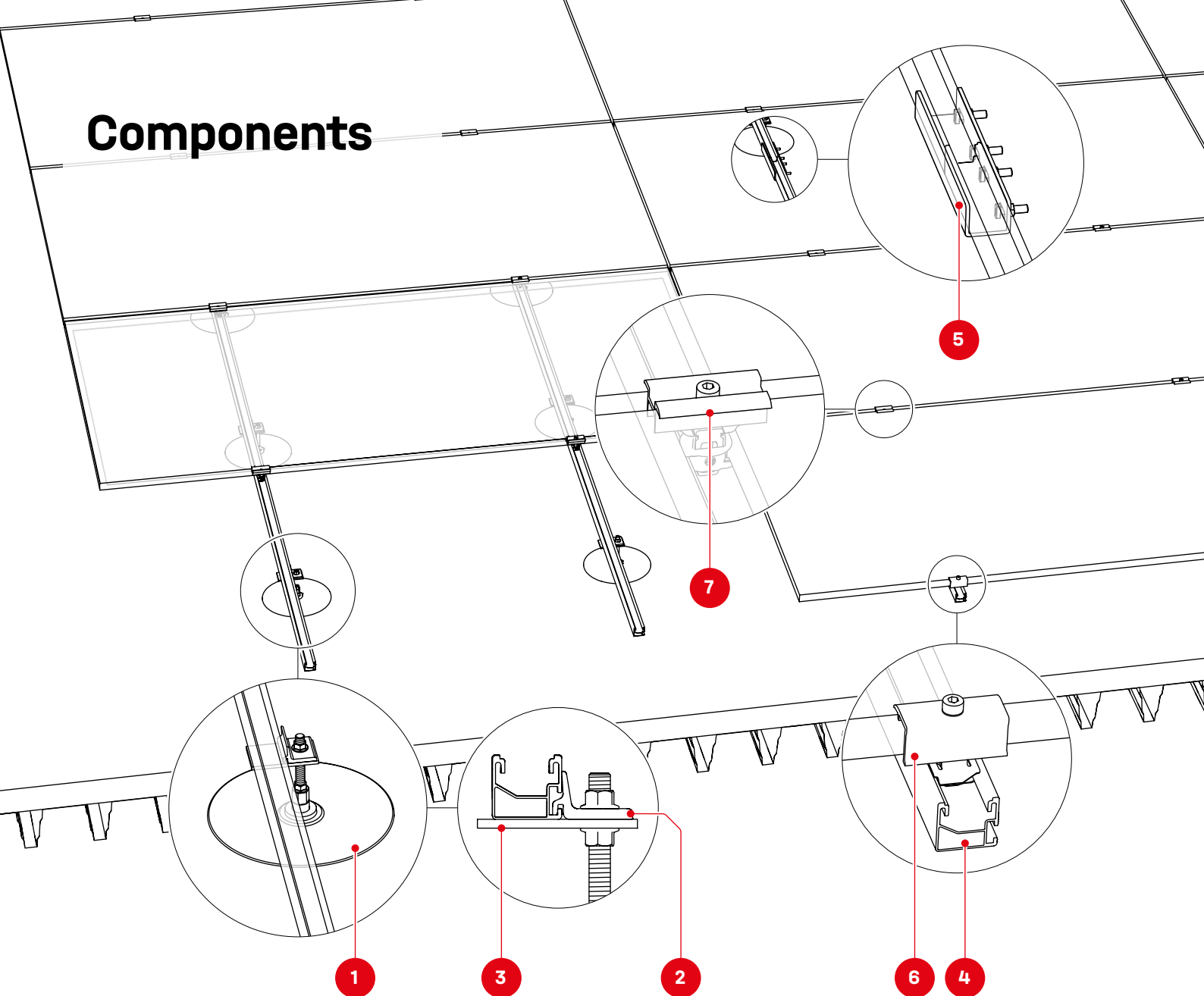

1 Roof anchor plate with adapter

Not included in the K2 product portfolio

Manufacturer: Sika, CW Lundberg, Solmont etc.

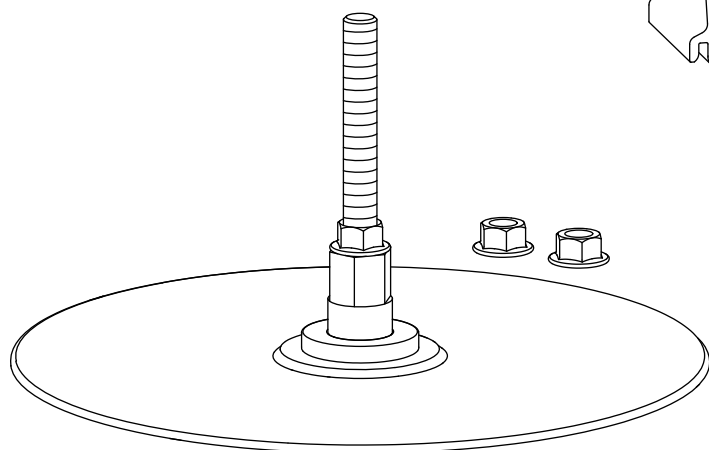

2 2003146/2003147 Climber 36/50 M10/ Climber 36/50 M12

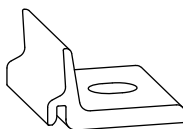

3 2002546/2002547 Adapter plate M10/ Adapter plate M12



- 4** Item number system-specific
SingleRail 36/SingleRail 50

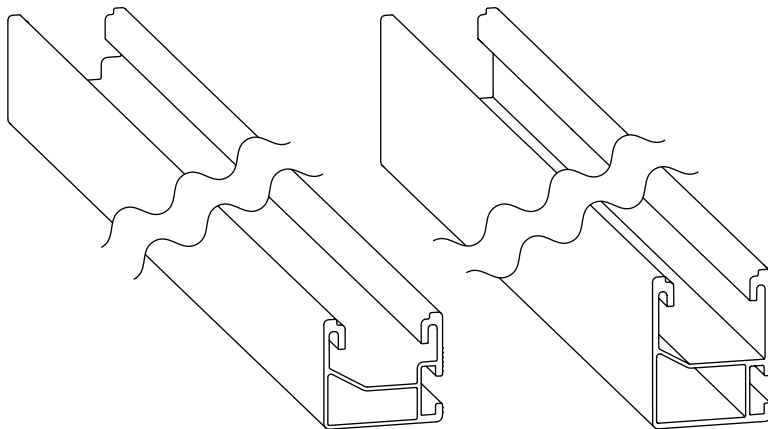

- 5** 2001976/2002404
**Rail connector Set
SingleRail 36/50**

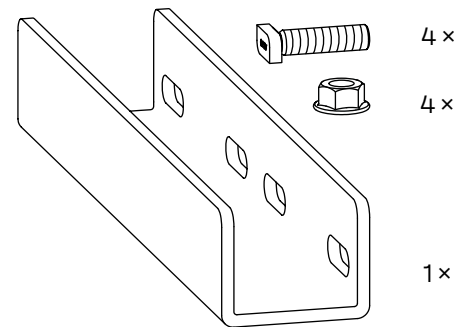

- 6** Item number system-specific
Module end clamps



K2 Clamp EC
25 - 40



XS Clamp EC
30 / 33 / 35



OneEnd
30-42



K2 Clamp EC
30 - 40, Hybrid

- 7** Item number system-specific
Module middle clamps

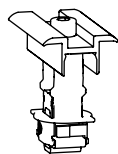

K2 Clamp MC
25 - 40



XS Clamp MC
30 / 33-35



OneMid
30-42

Optional

- 2001881
TerraGrif K2SZ

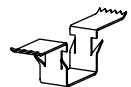

- 2004231
TerraGrif QL



- 2002870
Cable Manager

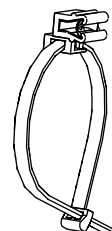

Assembly

Thermal separations - landscape

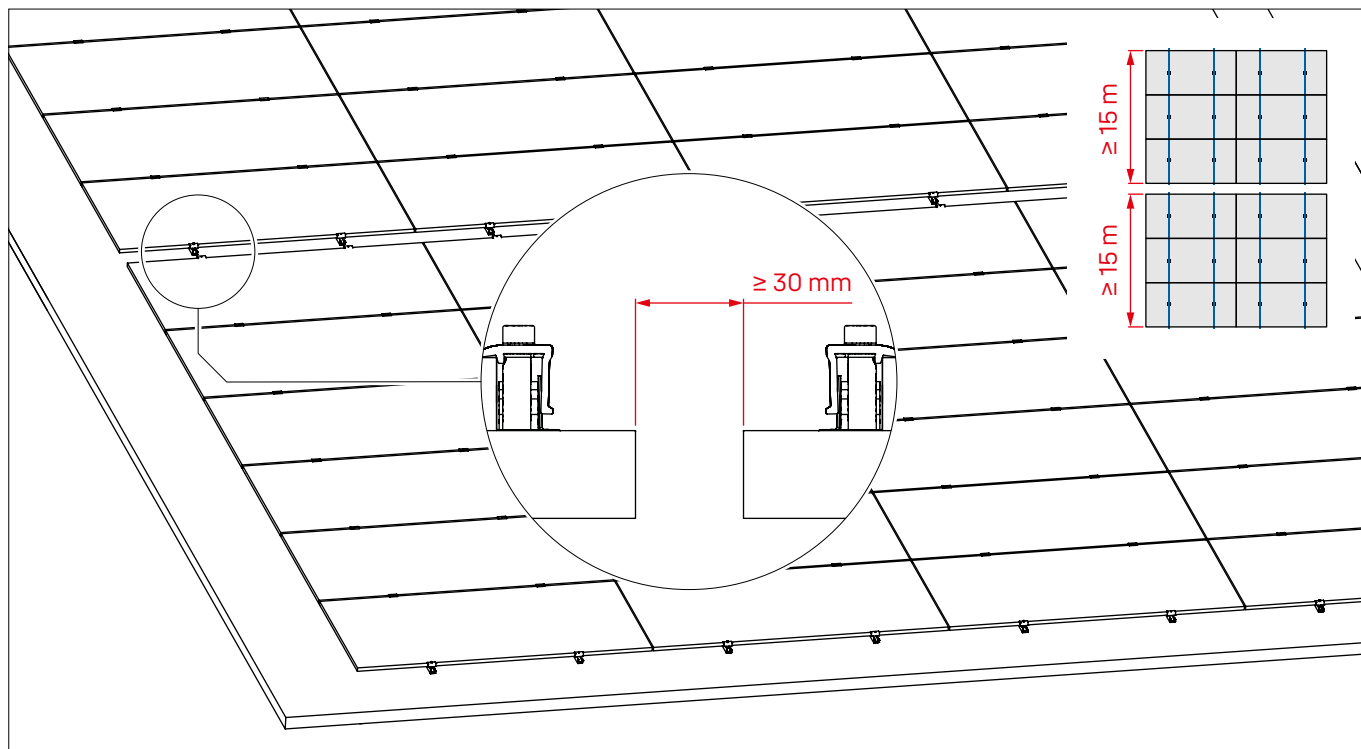

Set anchors - landscape

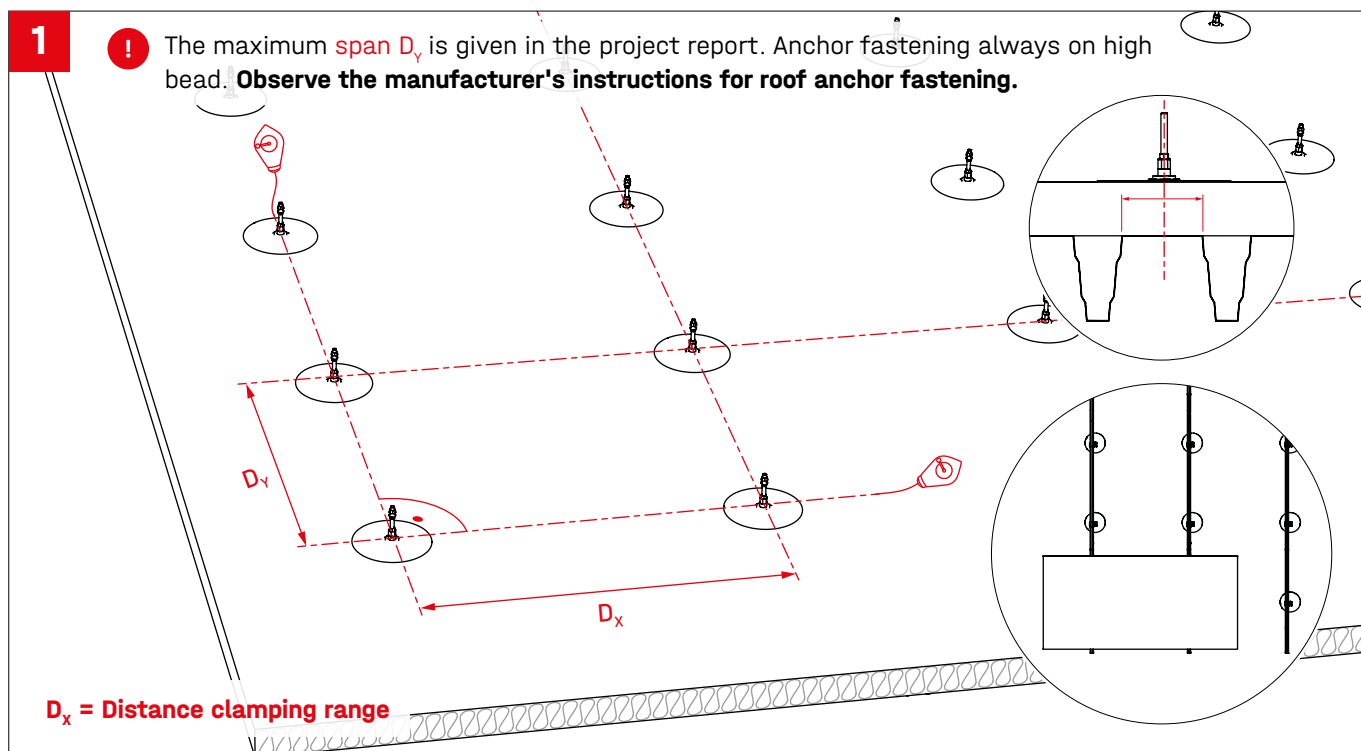

Thermal separations - portrait

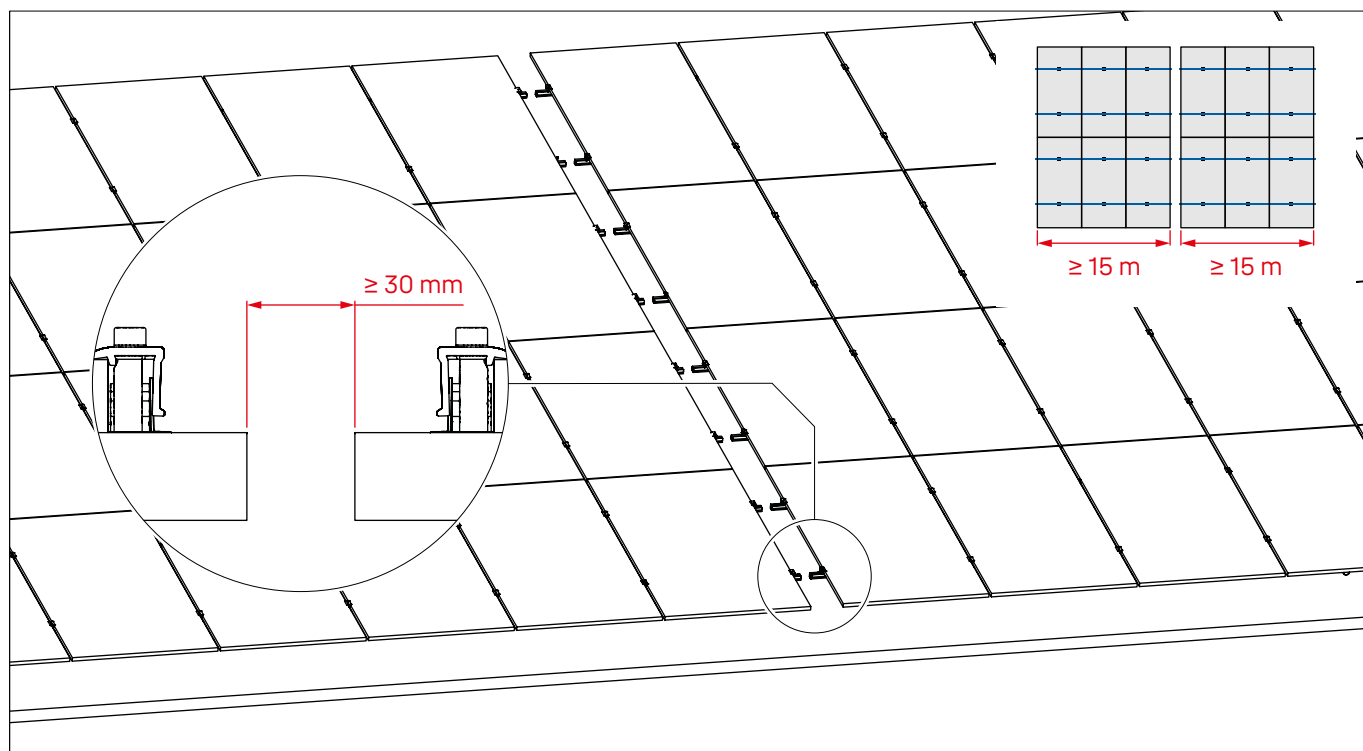

Set anchors - portrait

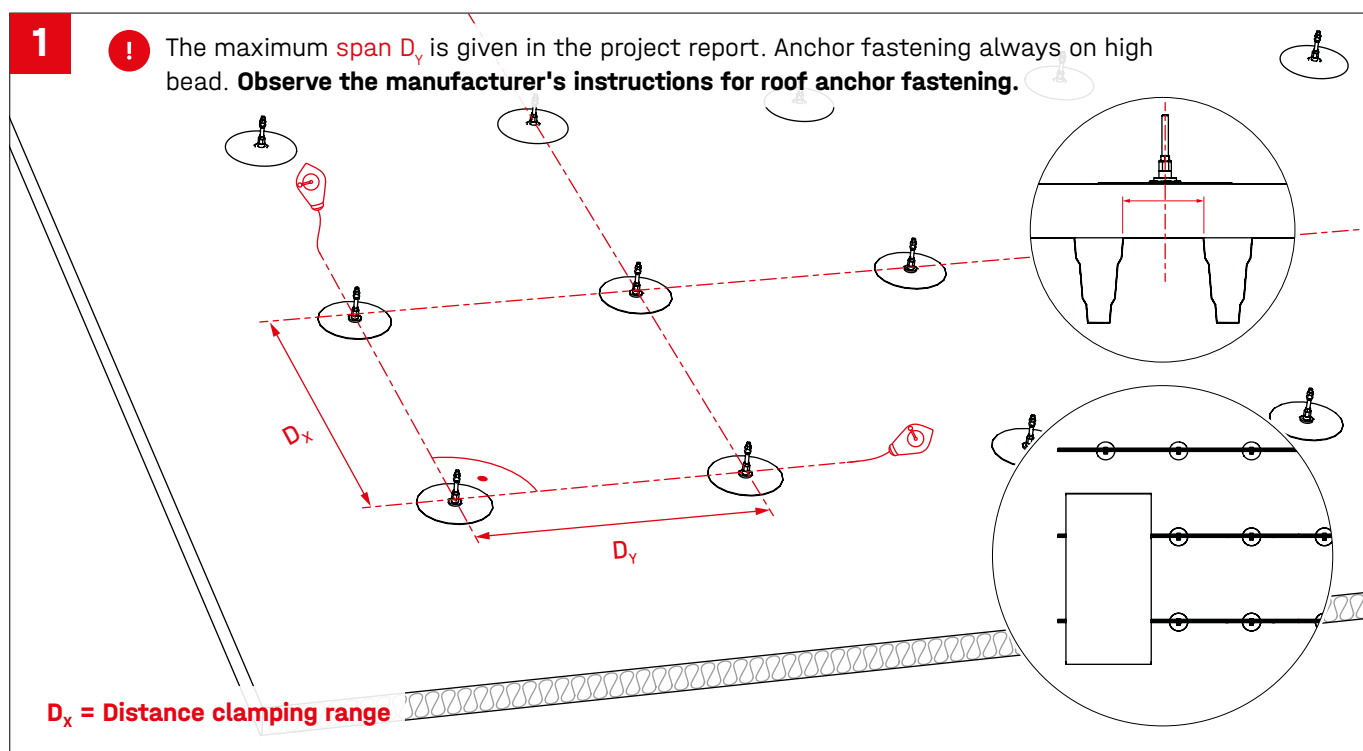

Rail attachment

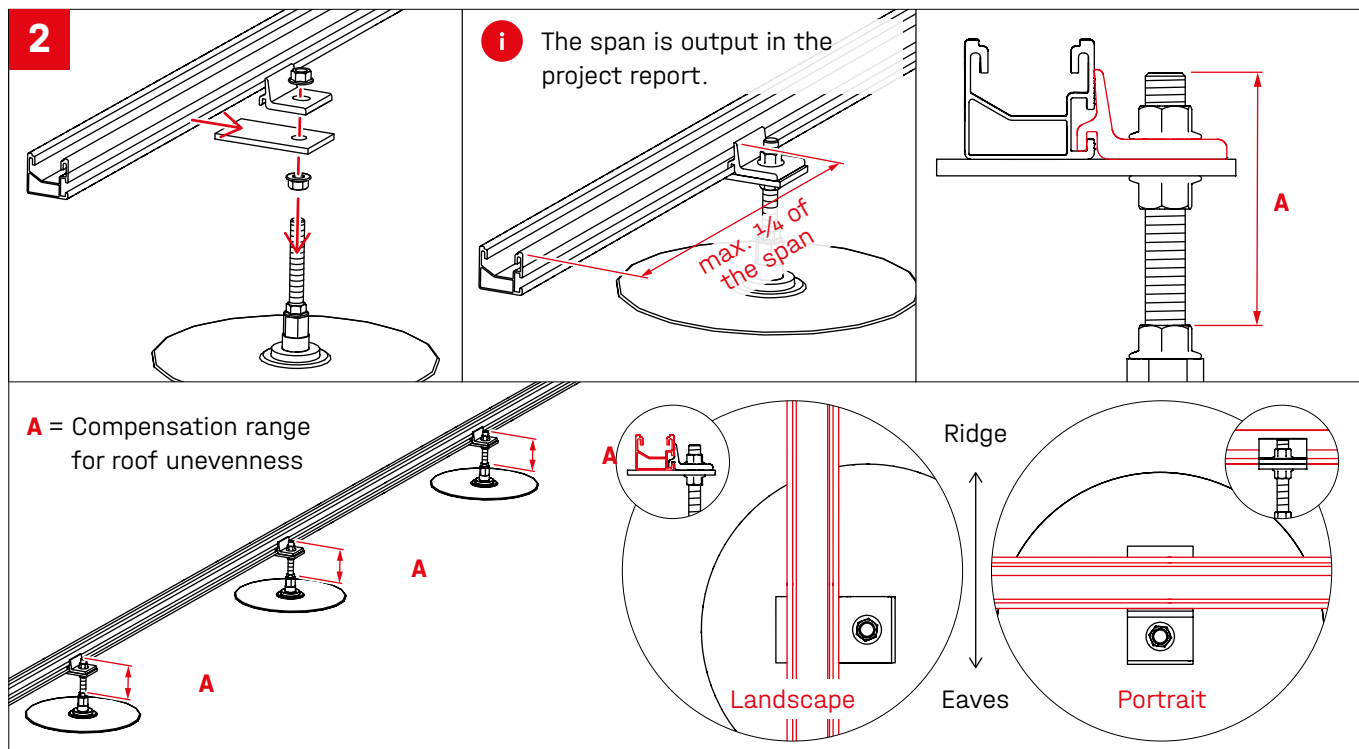

Connecting rails

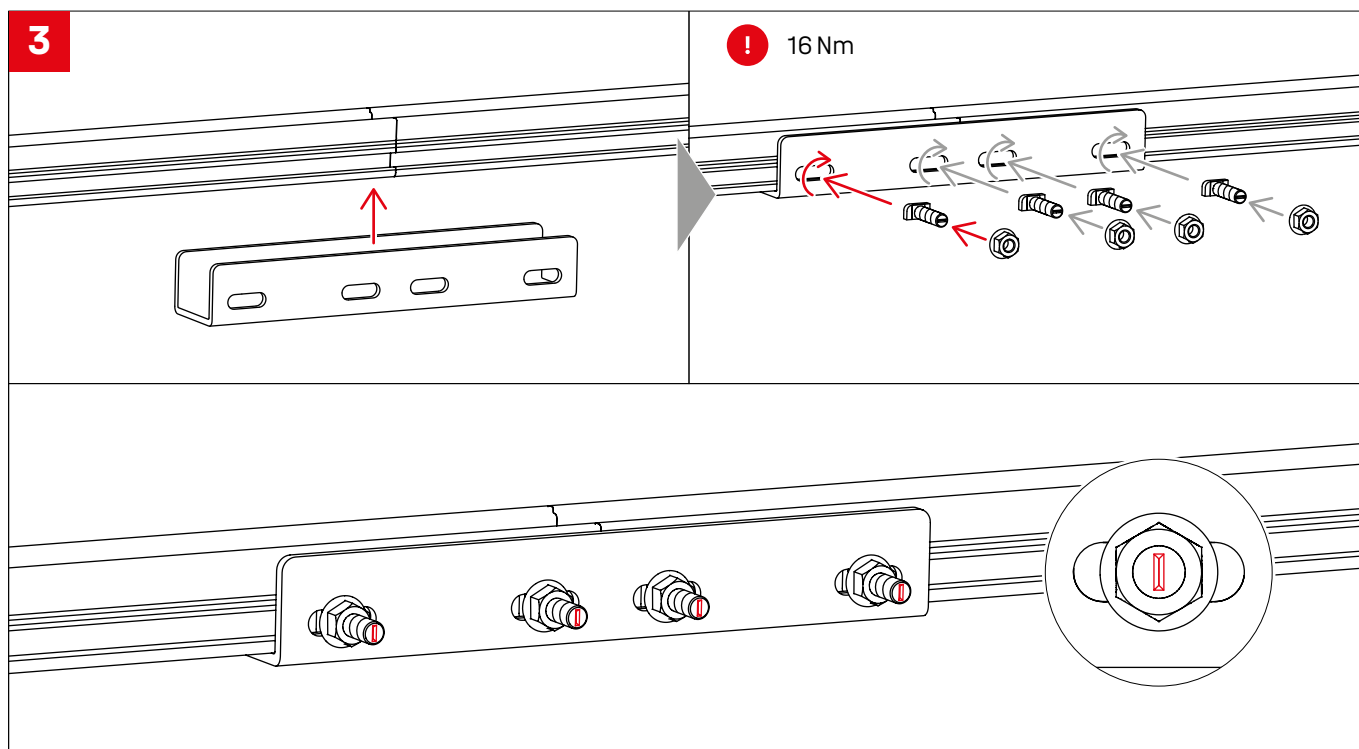

Module assembly - End clamp

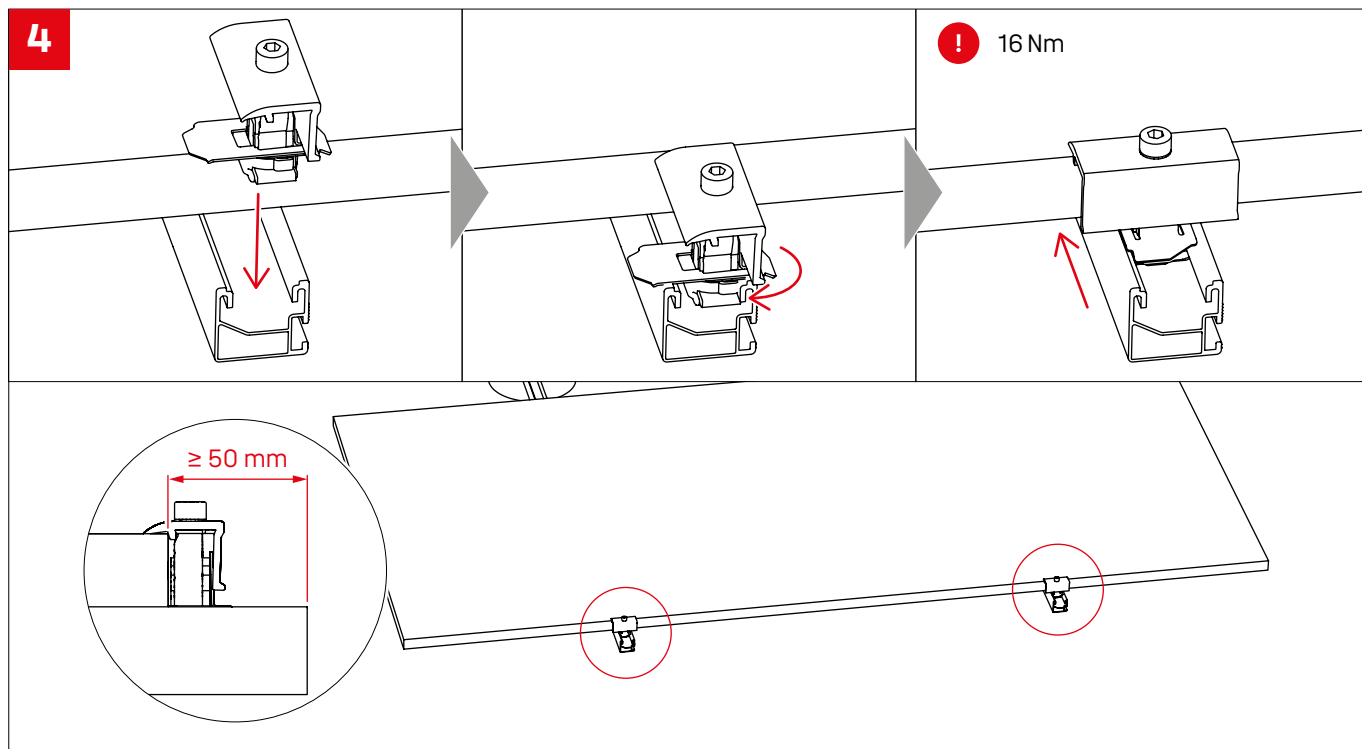

Module assembly - Middle clamp

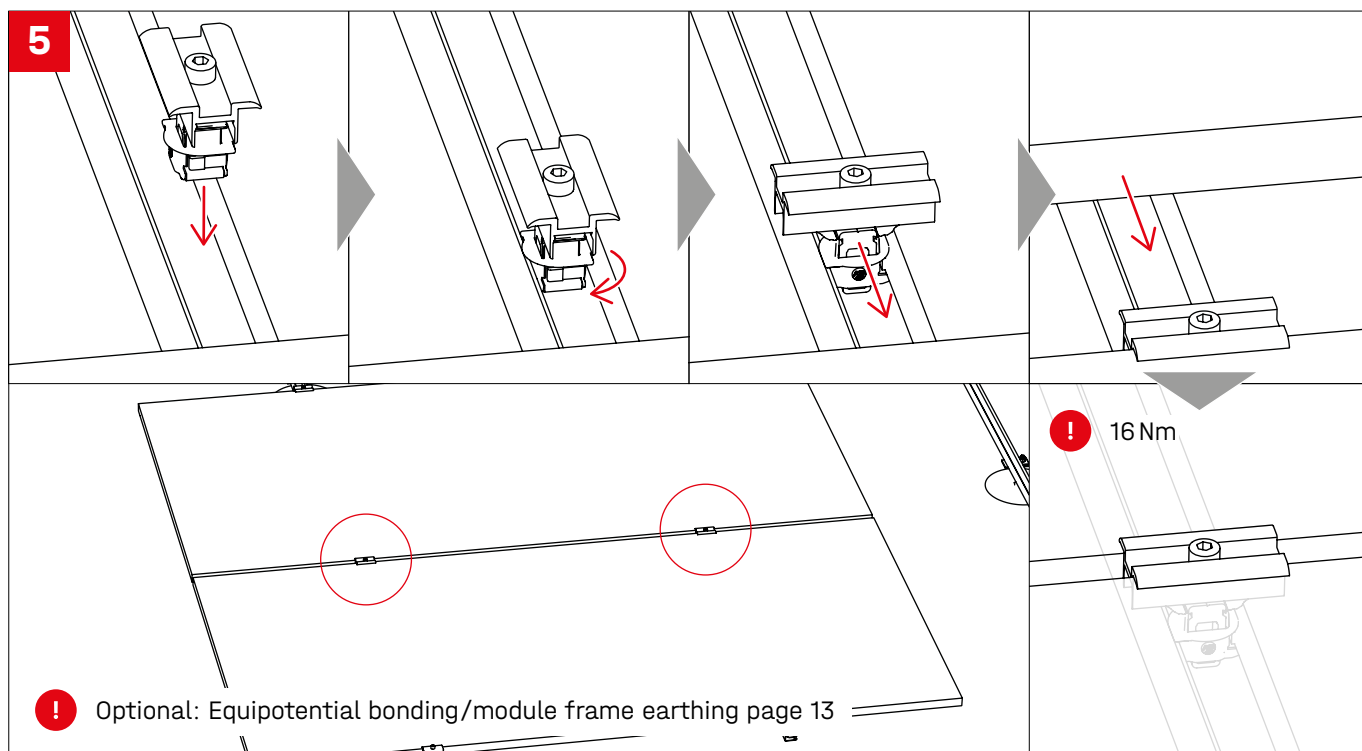

Module spacing in rail direction

Landscape

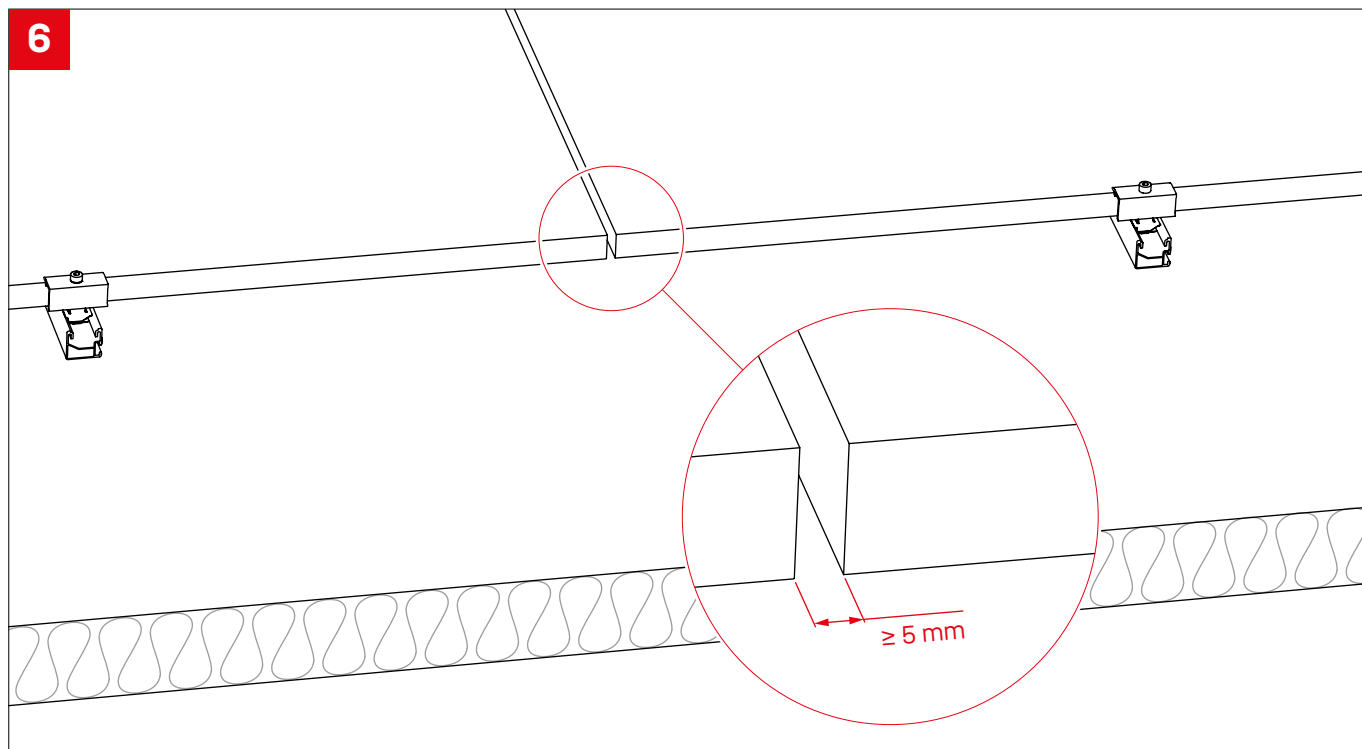

Portrait

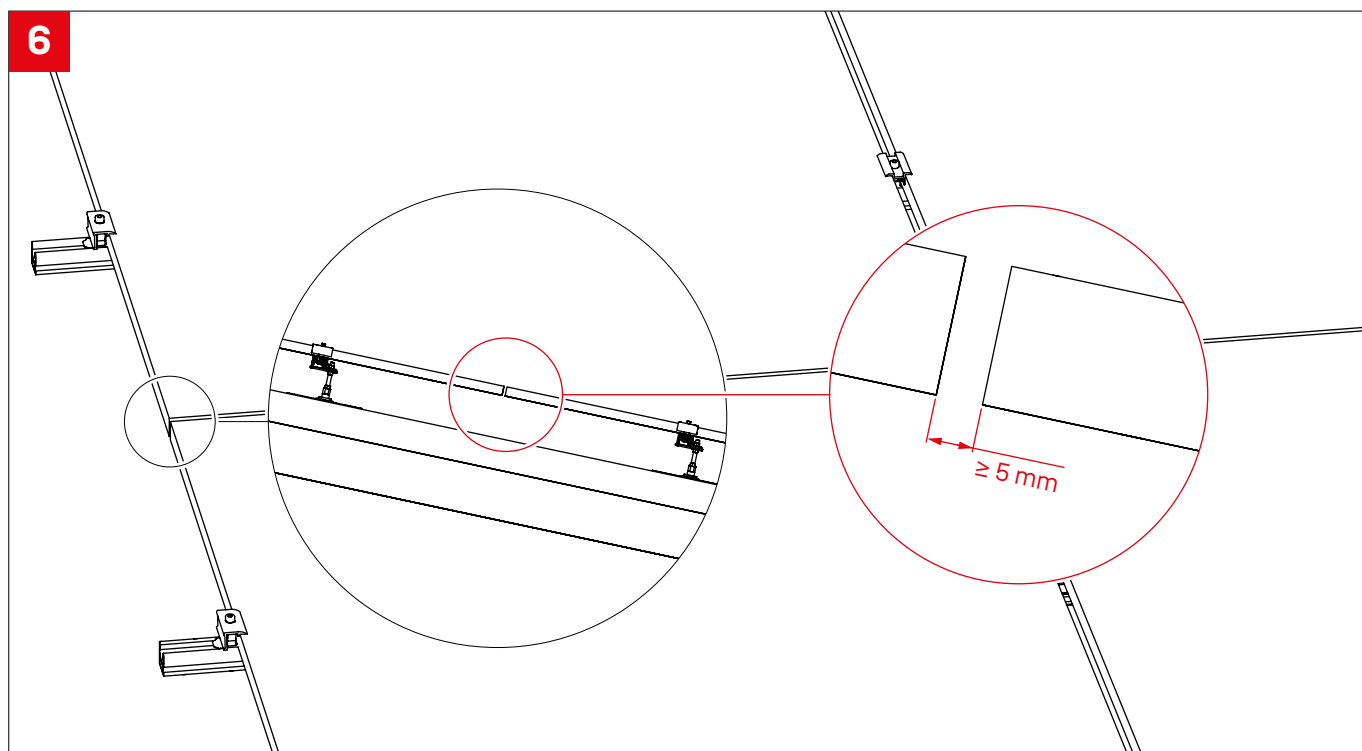

Equipotential bonding/ Module frame earthing



TerraGrif K2SZ

Compatible with universal and standard clamps

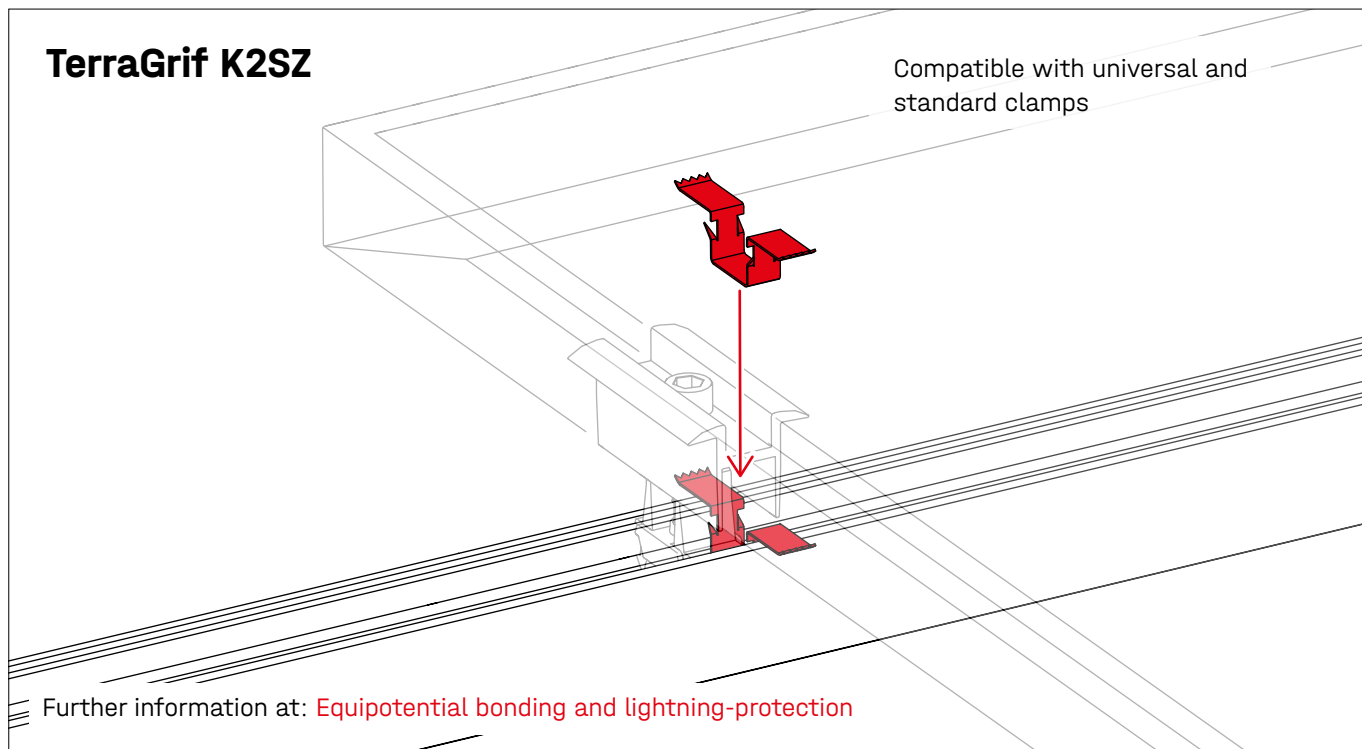

Further information at: [Equipotential bonding and lightning-protection](#)

TerraGrif QL

Compatible with module clamp
K2 Clamp 25-40

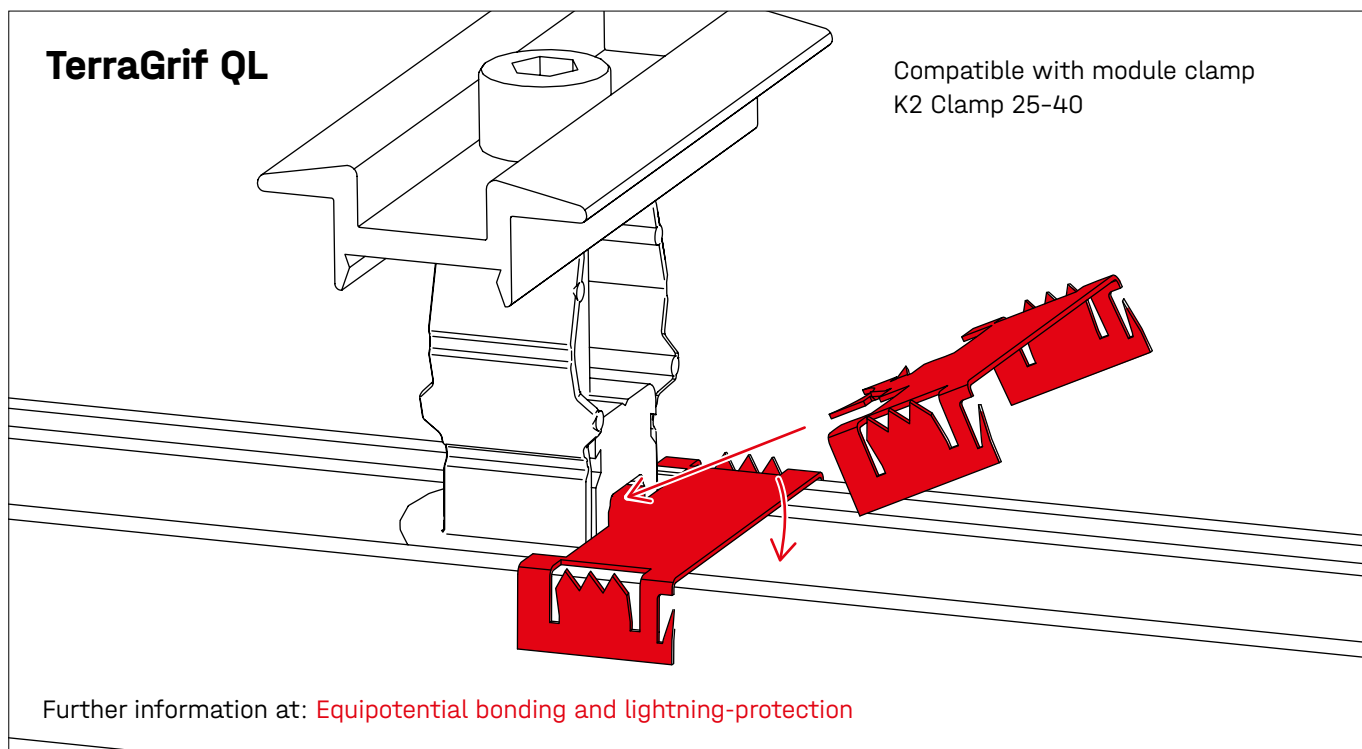

Further information at: [Equipotential bonding and lightning-protection](#)

Optional

Cable management with Cable Manager

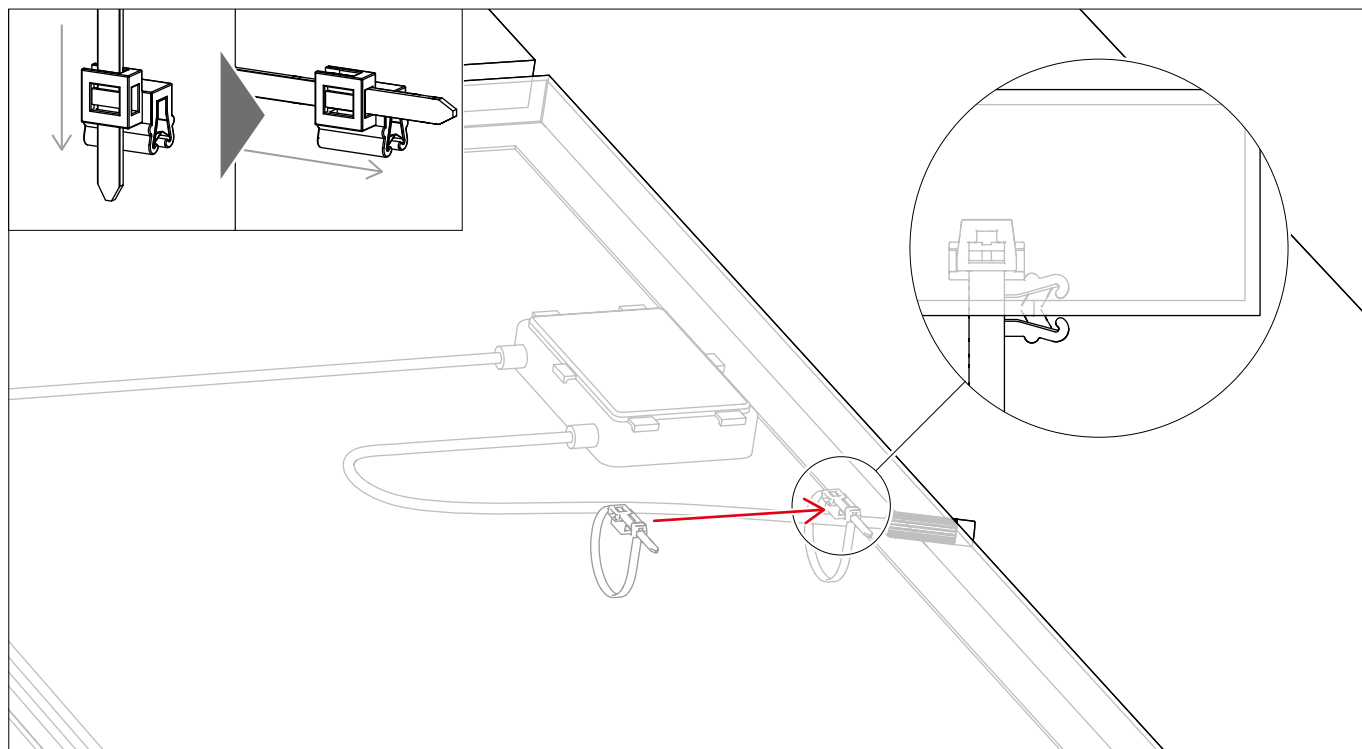

Notes



Thank you for choosing a K2 mounting system.

Mounting systems from K2 Systems are quick and easy to install. We hope these instructions have helped. Please contact us with any questions or suggestions for improvement. Our contact data:

- k2-systems.com/en/contact
- **Service Hotline: +49 7159 42059-0**

Our General Terms of Business apply. Please refer: k2-systems.com

K2 Systems GmbH

Haldenstraße 1 · 71272 Renningen · Germany
+49 (0) 7159 - 42059 - 0 · info@k2-systems.com · k2-systems.com

SingleRail IFP Assembly EN V1 | 0325 · Subject to change
Product illustrations are exemplary and may differ from the original.



Connecting Strength

k2-systems.com